

RECORDING REQUESTED BY AND  
WHEN RECORDED RETURN TO:

City of Santa Rosa  
Department of Planning & Economic Development  
Engineering Development Services  
100 Santa Rosa Ave, Room 5  
Santa Rosa, CA 95404

FREE RECORDING – GOVERNMENT CODE 27383  
R&T 11922 DEED TO PUBLIC AGENCY, -0- TRANSFER TAX DUE

**TEMPORARY CONSTRUCTION EASEMENT DEED**

SANTA ROSA HIGH SCHOOL DISTRICT

GRANTS TO

THE CITY OF SANTA ROSA, A MUNICIPAL CORPORATION:

A Temporary Construction Easement for a sixty one (61) day period of time commencing on June 8, 2026, and terminating on August 7, 2026, with a right of immediate entry and access for construction purposes including but not limited to installing of a public waterline and its attendant infrastructure in connection with the Rock Creek and Matanzas Water and Sewer Main Replacement Project (City of Santa Rosa Project Identification Number 2290) in, upon, over, across, through and under that certain real property situated in the City of Santa Rosa, County of Sonoma, State of California, as more particularly depicted on EXHIBIT "A-1" ATTACHED.

Together with the right to enter upon and to pass and repass over and along said easement and to trim, cut and clear away or otherwise control any tree or brush, and to deposit tools, implements and other materials thereon by said City of Santa Rosa, its officers, agents and employees and by any contractor, his agents and employees engaged by said City, whenever and wherever necessary for the purposes set forth above.

By executing this Temporary Construction Easement Deed, to which exhibits are attached, I/We, as owner(s) of the land shown hereon, do hereby state that I/We am/are the only person(s) whose consent is necessary to pass clear title to said land.

**A portion of A.P.N. 014-010-001, 014-251-010**

Date: \_\_\_\_\_

Santa Rosa High School District

By: \_\_\_\_\_

\_\_\_\_\_  
Name and Title

By: \_\_\_\_\_

\_\_\_\_\_  
Name and Title

[continues on following page]

NOTARY PUBLIC CERTIFICATE

A notary public or other officer completing this certificate verifies only the identity of the individual who signed the document to which this certificate is attached, and not the truthfulness, accuracy, or validity of that document.

STATE OF CALIFORNIA  
COUNTY OF SONOMA

On \_\_\_\_\_ before me, \_\_\_\_\_ personally appeared \_\_\_\_\_, who proved to me on the basis of satisfactory evidence to be the person(s) whose name(s) is/are subscribed to the within instrument and acknowledged to me that he/she/they executed the same in his/her/their authorized capacity(ies), and that by his/her/their signature(s) on the instrument the person(s), or the entity upon behalf of which the person(s) acted, executed the instrument.

I certify under PENALTY OF PERJURY under the laws of the State of California that the foregoing paragraph is true and correct.

WITNESS by my hand and official seal

Signature \_\_\_\_\_  
Signature of Notary Public

Place Notary Seal and/or Stamp Above

CERTIFICATE OF ACCEPTANCE

This is to certify that the interest in real property conveyed herein is hereby accepted by order of the Council of the City of Santa Rosa pursuant to Council Resolution/Ordinance No. 25533 January 21, 2003, and grantee consents to recordation thereof by its duly authorized officer.

CITY OF SANTA ROSA,  
A Municipal Corporation

By: \_\_\_\_\_

Dated: \_\_\_\_\_

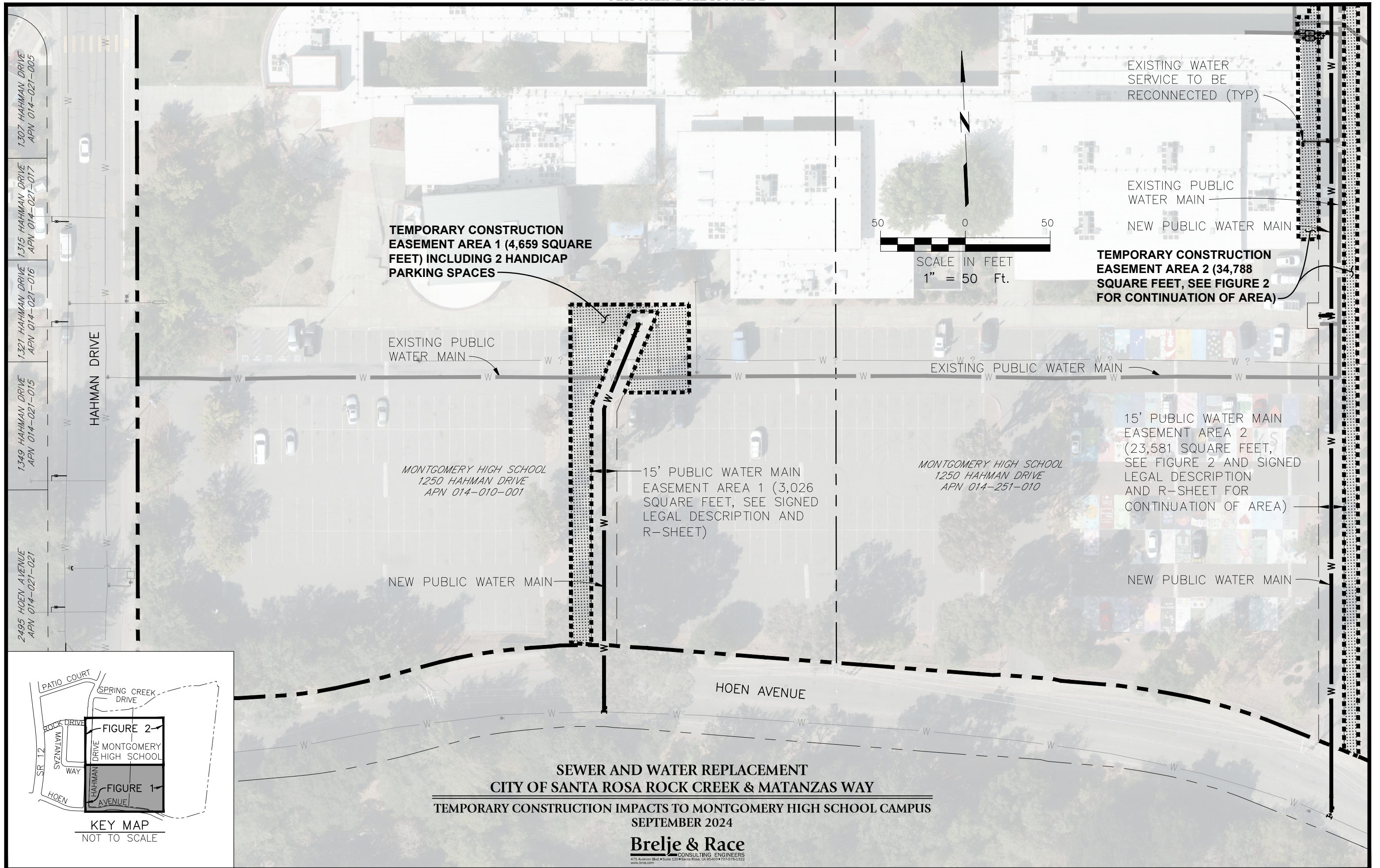

**SEWER AND WATER REPLACEMENT  
CITY OF SANTA ROSA ROCK CREEK & MATANZAS WAY  
TEMPORARY CONSTRUCTION IMPACTS TO MONTGOMERY HIGH SCHOOL CAMPUS  
SEPTEMBER 2024**

**Brelje & Race**  
CONSULTING ENGINEERS  
475 Aviation Blvd. • Suite 120 • Santa Rosa, CA 95403 • 707-576-1322  
www.brce.com

**FIGURE 1 - TCE AREA 1 AND A PORTION OF TCE AREA 2**

09-17-24 bryant 4698.dwg 4698 00 EXHIBIT A-1 EXHIBIT A-1 Temporary Construction Impacts.dwg TAB: Figure 2 - TCE AREA 2 ONLY

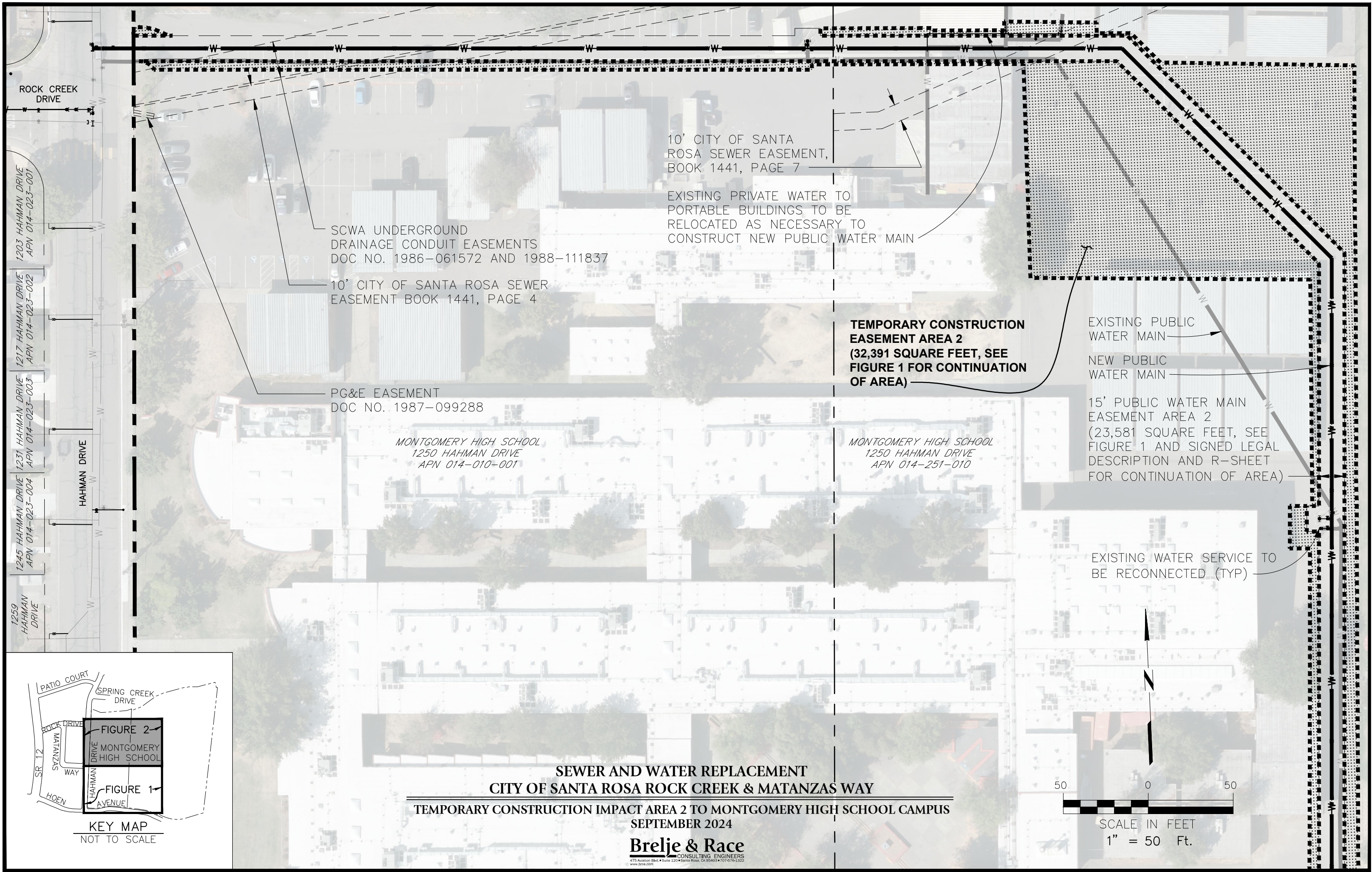

ROCK CREEK DRIVE

1203 HAHMAN DRIVE  
APN 014-023-001

1217 HAHMAN DRIVE  
APN 014-023-002

1231 HAHMAN DRIVE  
APN 014-023-003

1245 HAHMAN DRIVE  
APN 014-023-004

1259 HAHMAN DRIVE

HAHMAN DRIVE

10' CITY OF SANTA ROSA SEWER EASEMENT, BOOK 1441, PAGE 7

EXISTING PRIVATE WATER TO PORTABLE BUILDINGS TO BE RELOCATED AS NECESSARY TO CONSTRUCT NEW PUBLIC WATER MAIN

SCWA UNDERGROUND DRAINAGE CONDUIT EASEMENTS DOC NO. 1986-061572 AND 1988-111837

10' CITY OF SANTA ROSA SEWER EASEMENT BOOK 1441, PAGE 4

PG&E EASEMENT DOC NO. 1987-099288

MONTGOMERY HIGH SCHOOL  
1250 HAHMAN DRIVE  
APN 014-010-001

MONTGOMERY HIGH SCHOOL  
1250 HAHMAN DRIVE  
APN 014-251-010

**TEMPORARY CONSTRUCTION EASEMENT AREA 2 (32,391 SQUARE FEET, SEE FIGURE 1 FOR CONTINUATION OF AREA)**

EXISTING PUBLIC WATER MAIN

NEW PUBLIC WATER MAIN

15' PUBLIC WATER MAIN EASEMENT AREA 2 (23,581 SQUARE FEET, SEE FIGURE 1 AND SIGNED LEGAL DESCRIPTION AND R-SHEET FOR CONTINUATION OF AREA)

EXISTING WATER SERVICE TO BE RECONNECTED (TYP)

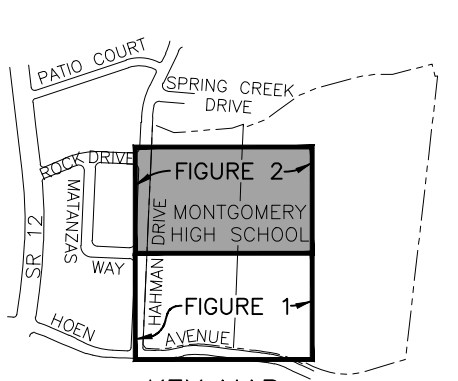

KEY MAP  
NOT TO SCALE

**SEWER AND WATER REPLACEMENT  
CITY OF SANTA ROSA ROCK CREEK & MATANZAS WAY**

**TEMPORARY CONSTRUCTION IMPACT AREA 2 TO MONTGOMERY HIGH SCHOOL CAMPUS  
SEPTEMBER 2024**

**Brelje & Race**  
CONSULTING ENGINEERS  
475 Aviation Blvd. • Suite 120 • Santa Rosa, CA 95403 • 707-976-1322  
www.brelje.com

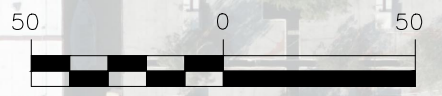

SCALE IN FEET  
1" = 50 Ft.

MATCHLINE SEE FIGURE 1

FIGURE 2 - A PORTION OF TCE AREA 2 ONLY