

# SANTA ROSA CITY SCHOOLS FACILITIES MASTER PLAN - 2026 UPDATE



## BOARD OF EDUCATION STUDY SESSION

MARCH 5, 2026

### AGENDA:

- Overview of FMP Update Process and Timeline
- Review of Draft FMP Sections for each school updated
  
- Next Steps
  - Community survey to gather input
  - QKA to produce final Site Master Plans based on Board and Community input
    - Including Cost Estimates and IoQ scores
    - Updated Introduction and Executive Summary
  - Present Final Draft at March 25th Meeting



# PROJECT DEVELOPMENT PROCESS

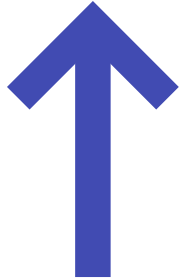

## MASTER PLANNING



CONTINUOUS  
STAKEHOLDER  
ENGAGEMENT

## PROGRAMMING

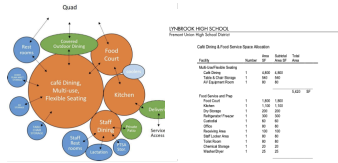

- General scope of projects
- Big picture budget
- Prioritization



## DESIGN



- Specific needs for each program
- Relationships between spaces

- Design and layout of buildings
- Landscape design
- Architecture and materials



LEVEL OF  
DETAIL

# PROJECT SELECTION

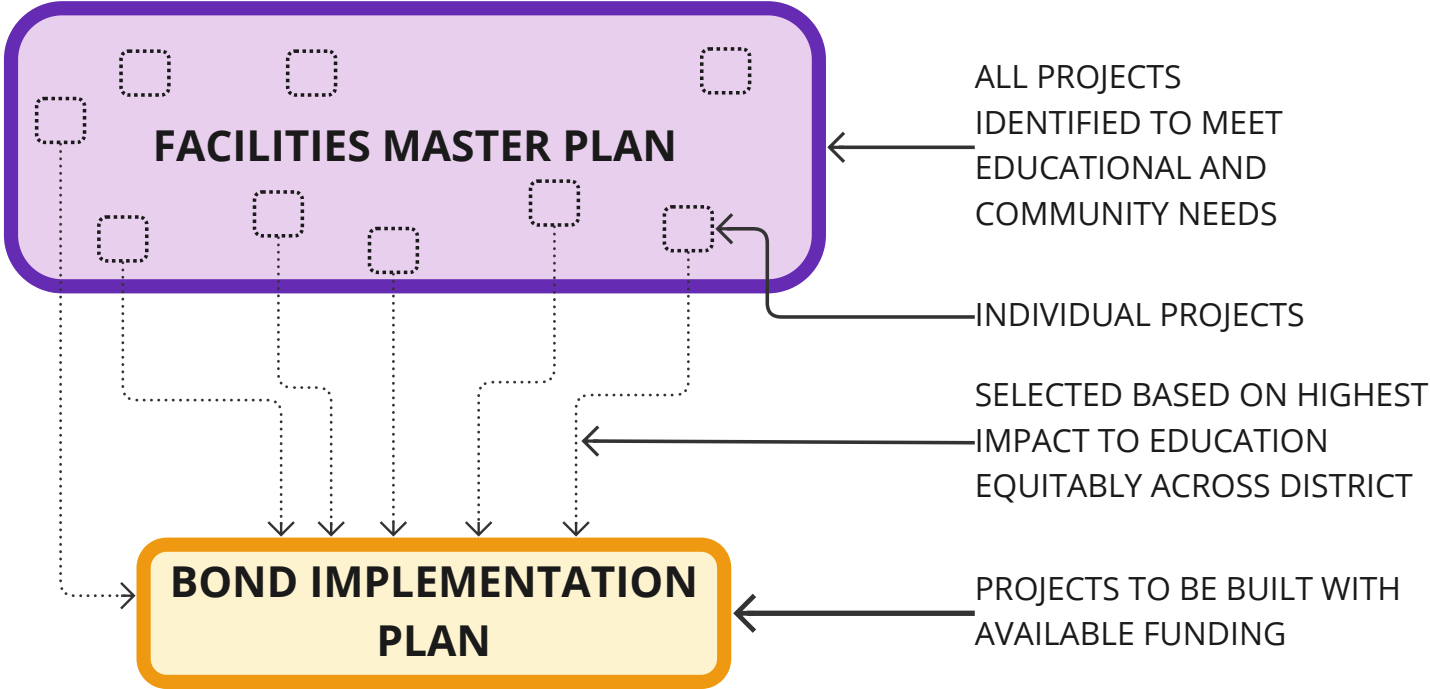

# FMP UPDATE PROCESS

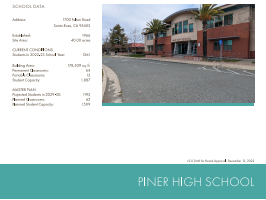

**2023 FMP**

+

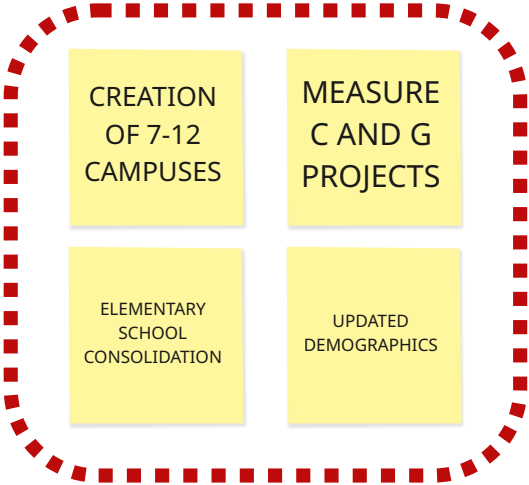

**CHANGED  
CONDITIONS**

=

**2026 FMP  
UPDATE**

*\*PROP 2 REQUIRES FMP UPDATE EVERY 5 YEARS*

# Indicators of Quality

## Tool for Prioritization

- Established IoQ as a way to objectively evaluate projects for 2016 FMP
- Intended to evaluate impact of each project on student success equitably across all projects
- To be updated for 2023 Master Plan
- Exec. Committee will bring draft IoQ definitions and weighting to Board for input

Indicator of Quality	Weighting	Multiplier	Max Score
IoQ1: Supports Ed. Programs	2	x10	20
IoQ2: Community Support	1	x10	10
IoQ3: Quality Learning Env.	2	x10	20
IoQ4: Maintenance and Ops.	3	x10	30
IoQ 5: Safety and Security	3	x10	30
IoQ 6: Code Compliance	1	x10	10
Total			120

## SCHOOL DATA

Address: 850 West Ninth Street  
Santa Rosa, CA 95401

Established: 1970  
Site Area: 6.15 acres

### CURRENT CONDITIONS

Students in 2022-23 School Year: 322  
Building Area: 43,179 sq. ft.  
Permanent Classrooms: 19  
Portable Classrooms: 8  
Student Capacity: 491

### MASTER PLAN

2030 Enrollment: 307  
2035 Enrollment: 359  
Planned Classrooms: 24  
Planned Student Capacity: 488



V3.0 Draft for Board Approval: February 25, 2026

# ABRAHAM LINCOLN ELEMENTARY SCHOOL



# > ABRAHAM LINCOLN ELEMENTARY SCHOOL

> SANTA ROSA CITY SCHOOLS DISTRICT | FACILITIES MASTER PLAN | 2431.00

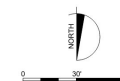

## SCHOOL DATA

Address: 1700 Jennings Avenue  
Santa Rosa, CA 95401

Established: 1970  
Site Area: 6.15 acres

### CURRENT CONDITIONS

Students in 2025-26 School Year: 485  
Building Area: 35,587 sq. ft.  
Permanent Classrooms: 19  
Portable Classrooms: 8  
Student Capacity: 560

### MASTER PLAN

2030 Enrollment: 512  
2035 Enrollment: 531  
Planned Classrooms: 27  
Planned Student Capacity: 588



V3.0 Draft for Board Approval: February 25, 2026

# HELEN LEHMAN ELEMENTARY SCHOOL

**SCHOOL CAPACITY**

2025-2026 ENROLLMENT: 485  
 2030 PROJECTED ENROLLMENT: 512  
 2035 PROJECTED ENROLLMENT: 531  
 EXISTING: 447  
 PROPOSED: 576



**> HELEN LEHMAN ELEMENTARY SCHOOL**

> SANTA ROSA CITY SCHOOLS DISTRICT | FACILITIES MASTER PLAN | 2431.00

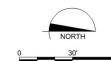

## SCHOOL DATA

Address: 3435 Bonita Vista  
Santa Rosa, CA 95404

Established: 1975

Site Area: 9.88 acres

### CURRENT CONDITIONS

Students in 2025-26 School Year: 503

Building Area: 11,040 sq. ft.

Permanent Classrooms: 29

Portable Classrooms: 3

Student Capacity: 623

### MASTER PLAN

2030 Enrollment: 516

2035 Enrollment: 603

Planned Classrooms: 30

Planned Student Capacity: 632



V3.0 Draft for Board Approval: February 25, 2026

# HIDDEN VALLEY ELEMENTARY SCHOOL

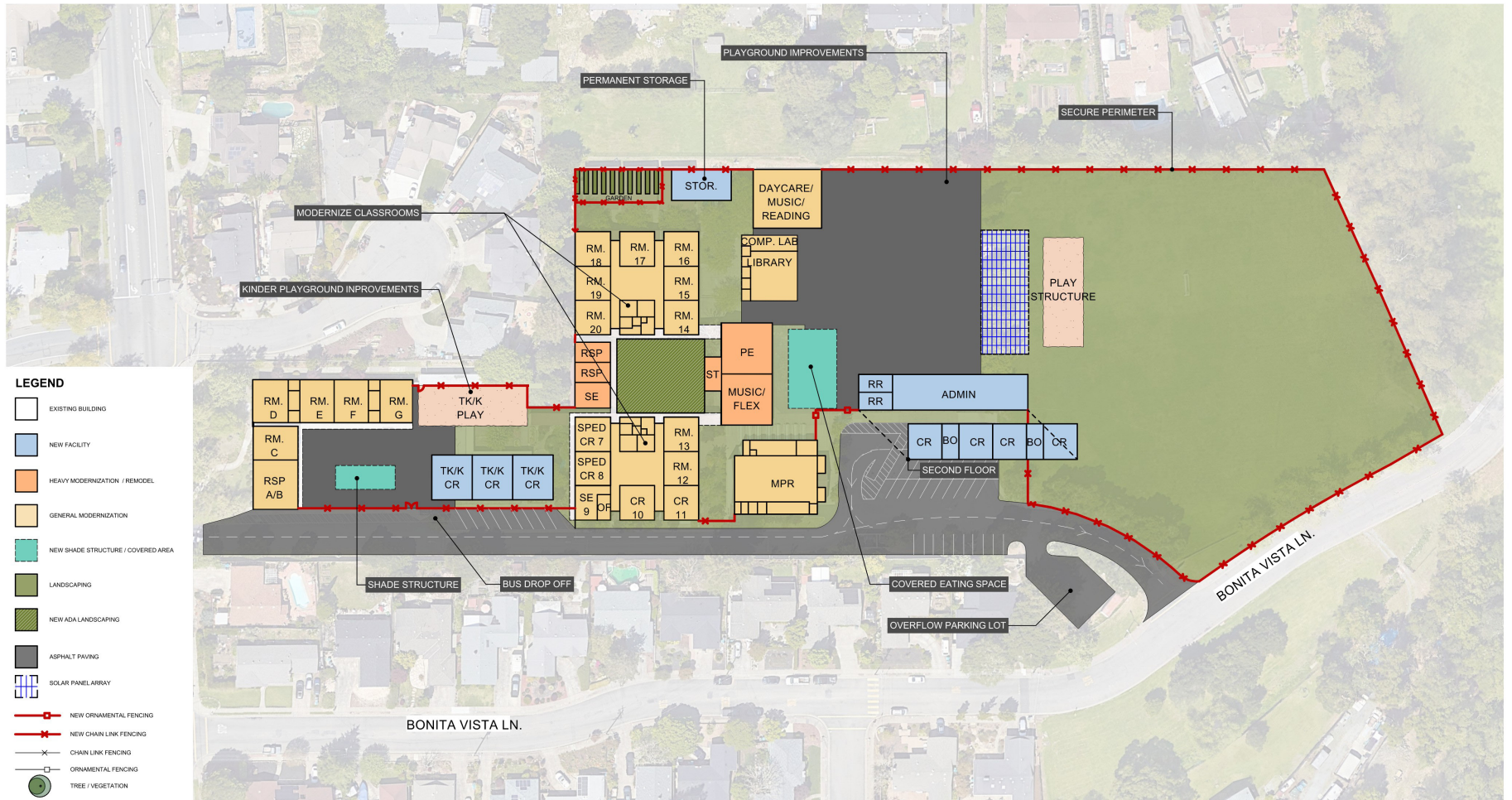

# > HIDDEN VALLEY ELEMENTARY SCHOOL

> SANTA ROSA CITY SCHOOLS DISTRICT | FACILITIES MASTER PLAN | 2431.00

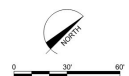

## SCHOOL DATA

Address: 203 South A Street  
Santa Rosa, CA 95401

Established: 1958

Site Area: 5.47 acres

### CURRENT CONDITIONS

Students in 2025-26 School Year: 459

Building Area: 35,791 sq. ft.

Permanent Classrooms: 23

Portable Classrooms: 1

Student Capacity: 494

### MASTER PLAN

2030 Enrollment: 384

2035 Enrollment: 447

Planned Classrooms: 24

Planned Student Capacity: 460



V3.0 Draft for Board Approval: February 25, 2026

# LUTHER BURBANK ELEMENTARY SCHOOL



## SCHOOL DATA

Address: 2567 Marlow Road  
Santa Rosa, CA 95403

Established: 1961  
Site Area: 12.40 acres

### CURRENT CONDITIONS

Students in 2025-26 School Year: 418  
Building Area: 45,946 sq. ft.  
Permanent Classrooms: 25  
Portable Classrooms: 13  
Student Capacity: 527

### MASTER PLAN

2030 Enrollment: 473  
2035 Enrollment: 565  
Planned Classrooms: 30  
Planned Student Capacity: 608



V3.0 Draft for Board Approval: February 25, 2026

# JAMES MONROE ELEMENTARY SCHOOL



## > JAMES MONROE ELEMENTARY SCHOOL

> SANTA ROSA CITY SCHOOLS DISTRICT | FACILITIES MASTER PLAN | 2431.00

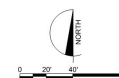

## SCHOOL DATA

Address: 1711 Bryden Lane  
Santa Rosa, CA 95404

Established: 1950  
Site Area: 5.18 acres

### CURRENT CONDITIONS

Students in 2022-23 School Year: 335  
Building Area: 40,262 sq. ft.  
Permanent Classrooms: 13  
Portable Classrooms: 9  
Student Capacity: 466

### MASTER PLAN

2030 Enrollment: 394  
2035 Enrollment: 471  
Planned Classrooms: 24  
Planned Student Capacity: 503



V3.0 Draft for Board Approval: February 25, 2026

# PROCTOR TERRACE ELEMENTARY SCHOOL



## SCHOOL DATA

Address: 756 Humboldt St.  
Santa Rosa, CA 95404

Established: 1921  
Site Area: 4.06 acres

### CURRENT CONDITIONS

Students in 2022-23 School Year: 391

Building Area: 28,297 sq. ft.  
Permanent Classrooms: 16  
Portable Classrooms: 5  
Student Capacity: 504

### MASTER PLAN

Projected Students in 2029-30: 426  
Planned Classrooms: 25  
Planned Student Capacity: 524



v2.0 Draft for Board Approval: December 13, 2023

# SANTA ROSA CHARTER FOR ARTS

**SCHOOL CAPACITY**

2022-2023 ENROLLMENT: 391  
 2029-30 PROJECTED ENROLLMENT: 426  
 EXISTING: 504  
 PROPOSED: 532

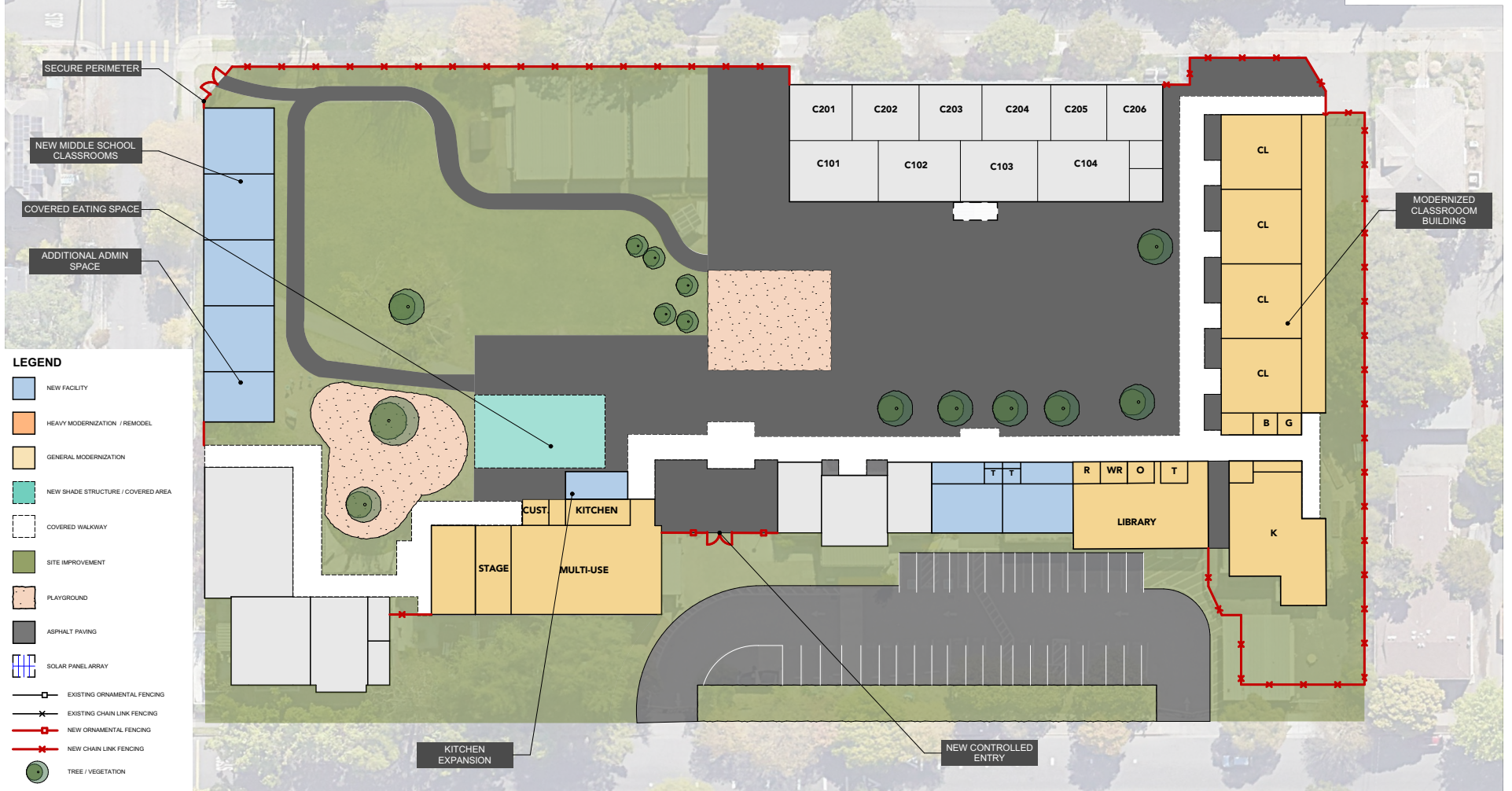

**> SANTA ROSA CHARTER SCHOOL FOR THE ARTS**

> SANTA ROSA CITY SCHOOLS DISTRICT | FACILITIES MASTER PLAN | 2177.00

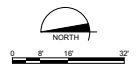

## SCHOOL DATA

Address: 500 E Street  
Santa Rosa, CA 95404

Established: 1949  
Site Area: 10.2 acres

CURRENT CONDITIONS  
Students in 2025-26 School Year: 496

FORMER SRMS CAMPUS  
Building Area: 84,865 sq. ft.  
Permanent Classrooms: 30  
Portable Classrooms: 1  
Student Capacity: 754

MASTER PLAN  
2030 Enrollment: 0  
2035 Enrollment: 0  
Planned Classrooms: 40  
Planned Student Capacity: 725



V3.0 Draft for Board Approval: February 25, 2026

# SANTA ROSA FRENCH-AMERICAN CHARTER



# > SANTA ROSA FRENCH AMERICAN CHARTER SCHOOL

> SANTA ROSA CITY SCHOOLS DISTRICT | FACILITIES MASTER PLAN | 2431.00



## SCHOOL DATA

Address: 2480 Sebastopol Rd  
Santa Rosa, CA 95407

Established: Campus - 1959, CCLA - 2013  
Site Area: 24.08 acres

## CURRENT CONDITIONS

Students in 2022-23 School Year: 853  
Building Area: 95,021 sq. ft.  
Permanent Classrooms: 34  
Portable Classrooms: 16  
Student Capacity: 1,199

## MASTER PLAN

Projected Students in 2029-30: 807  
Planned Classrooms: 43  
Planned Student Capacity: 1,010



v2.0 Draft for Board Approval: December 13, 2023

# CESAR CHAVEZ LANGUAGE ACADEMY

**SCHOOL CAPACITY**

2022-2023 ENROLLMENT: 853  
 2026-30 PROJECTED ENROLLMENT: 807  
 EXISTING: 1199  
 PROPOSED: 1077

**LEGEND**

- NEW FACILITY
- HEAVY MODERNIZATION / REMODEL
- GENERAL MODERNIZATION
- NEW SHADE STRUCTURE / COVERED AREA
- COVERED WALKWAY
- SITE IMPROVEMENT
- PLAYGROUND
- ASPHALT PAVING
- SOLAR PANEL ARRAY
- EXISTING ORNAMENTAL FENCING
- EXISTING CHAIN LINK FENCING
- NEW ORNAMENTAL FENCING
- NEW CHAIN LINK FENCING
- TREE / VEGETATION

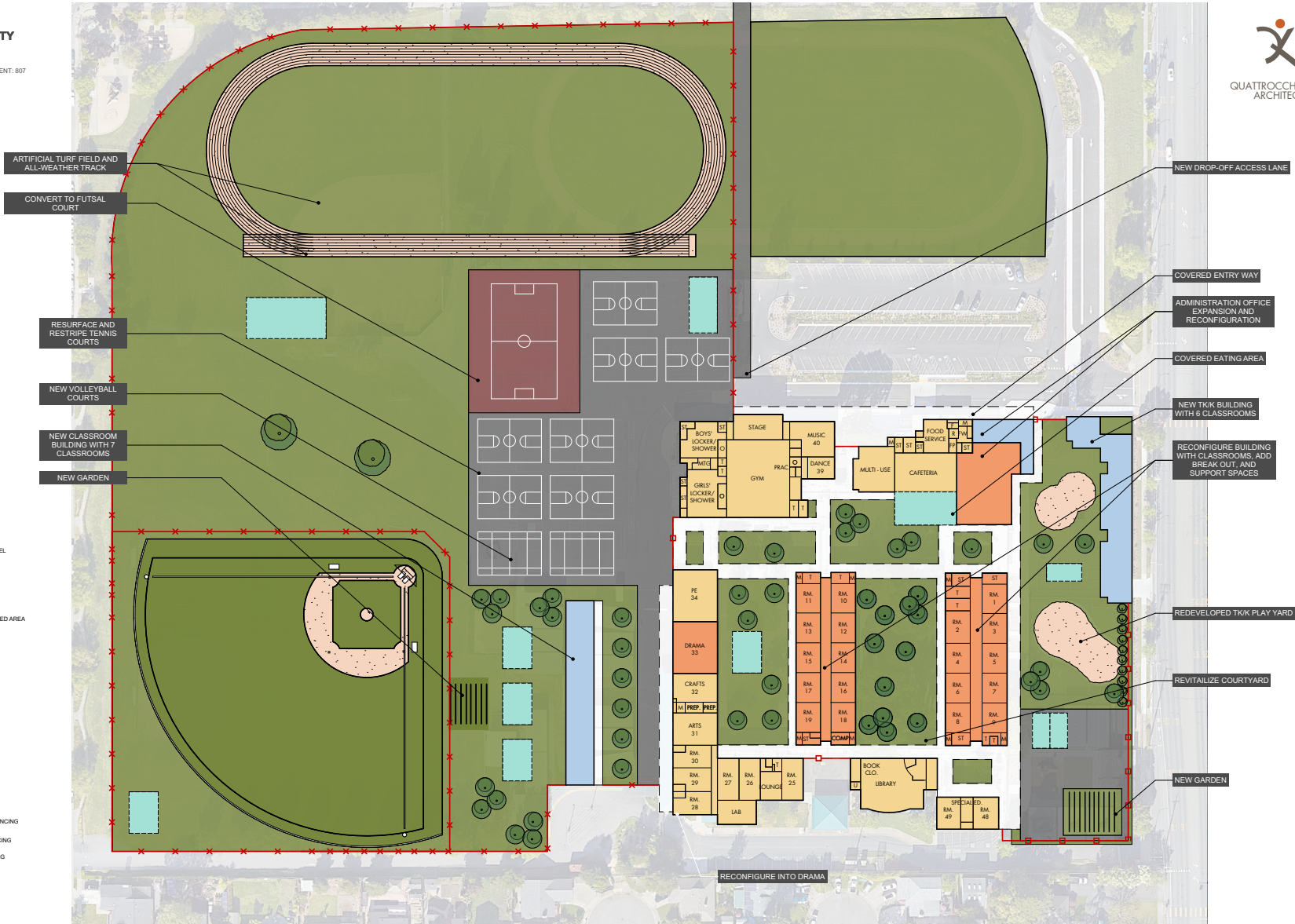

**> CESEAR CHAVEZ LANGUAGE ACADEMY MIDDLE SCHOOL**

> SANTA ROSA CITY SCHOOLS DISTRICT | FACILITIES MASTER PLAN | 2177.00

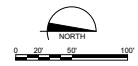

## SCHOOL DATA

Address: 599 Bellevue Ave  
Santa Rosa, CA 95407

Established: 1994

Site Area: 40.75 acres

### CURRENT CONDITIONS

Students in 2025-26 School Year: 933

Building Area: 174,924 sq. ft.

Permanent Classrooms: 56

Portable/Modular Classrooms: 19

Student Capacity: 1,942

### MASTER PLAN

2030 Enrollment: 927

2035 Enrollment: 922

Planned Classrooms: 49

Planned Student Capacity: 1212



V3.0 Draft for Board Approval: February 25, 2026

# ELSIE ALLEN JUNIOR & SENIOR HIGH SCHOOL



**LEGEND**

- NEW FACILITY / NUEVO EDIFICIO
- HEAVY MODERNIZATION / REMODEL GRANDES CAMBIOS DE RENOVACION
- GENERAL MODERNIZATION / MODERNIZACION GENERAL
- NEW SHADE STRUCTURE / COVERED AREA / NUEVA ESTRUCTURA DE SOMBRA
- COVERED WALKWAY / NUEVO CAMINO CUBIERTO
- SITE IMPROVEMENT / MEJORA DE SITIO
- PLAYGROUND / JARDIN DE NIÑOS
- ASPHALT PAVING / ASFALTO PAVIMENTADO
- SOLAR PANEL ARRAY / CUBIERTA CON PANELES SOLARES
- EXISTING ORNAMENTAL FENCING / CERCA ORNAMENTAL EXISTENTE
- EXISTING CHAIN LINK FENCING / CERCA CON MALLA DE ALAMBRE EXISTENTE
- NEW ORNAMENTAL FENCING / NUEVA CERCA ORNAMENTAL
- NEW CHAIN LINK FENCING / NUEVA CERCA CON MALLA DE ALAMBRE
- TREE / VEGETATION ARBOLES Y VEGETACION

# > ELSIE ALLEN HIGH SCHOOL

> SANTA ROSA CITY SCHOOLS DISTRICT | FACILITIES MASTER PLAN | 2431.00

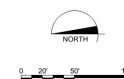

## SCHOOL DATA

Address: 6975 Montecito Blvd.  
Santa Rosa, CA 95409

Established: 1995

Site Area: 39.97 acres

### CURRENT CONDITIONS

Students in 2025-26 School Year: 1,582

Building Area: 154,334 sq. ft.

Permanent Classrooms: 48

Portable/Modular Classrooms: 16

Student Capacity: 1,517

### MASTER PLAN

2030 Enrollment: 2,041

2035 Enrollment: 2,082

Planned Classrooms: 86

Planned Student Capacity: 2,111



V3.0 Draft for Board Approval: February 25, 2026

# MARIA CARRILLO JUNIOR & SENIOR HIGH SCHOOL

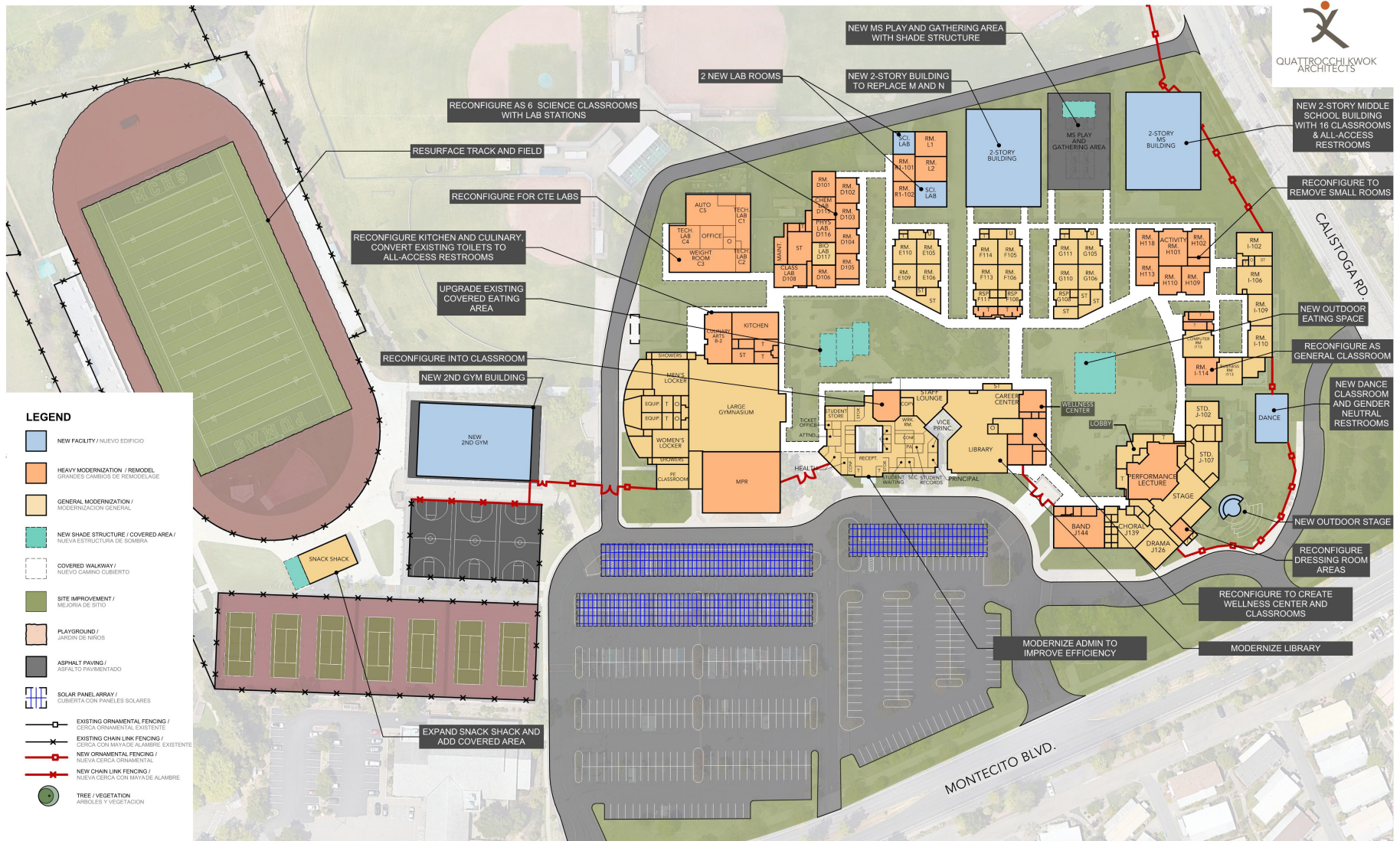

# > MARIA CARRILLO HIGH SCHOOL

> SANTA ROSA CITY SCHOOLS DISTRICT | FACILITIES MASTER PLAN | 2431.00

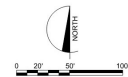

## SCHOOL DATA

Address: 1250 Hahman Dr.  
Santa Rosa, CA 95405

Established: 1958  
Site Area: 40.70 acres

### CURRENT CONDITIONS

Students in 2025-26 School Year: 1680  
Building Area: 174,756 sq. ft.  
Permanent Classrooms: 67  
Portable Classrooms: 26  
Student Capacity: 2,219

### MASTER PLAN

2030 Enrollment: 1,485  
2035 Enrollment: 1,508  
Planned Classrooms: 69  
Planned Student Capacity: 1,722



V3.0 Draft for Board Approval: February 25, 2026

# MONTGOMERY JUNIOR & SENIOR HIGH SCHOOL



## SCHOOL DATA

Address: 1700 Fulton Road  
Santa Rosa, CA 95403

Established: 1966  
Site Area: 40.00 acres

### CURRENT CONDITIONS

2025-2026 Enrollment: 1539

Building Area: 178,509 sq. ft.  
Permanent Classrooms: 68  
Portable Classrooms: 8  
Student Capacity: 1,807  
(Not including new building under construction)

### MASTER PLAN

2030 Projected Enrollment: 1562  
2035 Projected Enrollment: 1562  
Planned Capacity: 1642



V3.0 Draft for Board Approval: February 25, 2026

# PINER HIGH SCHOOL



## SCHOOL DATA

Address: 325 Ridgway Avenue  
Santa Rosa, CA 95401

Established: 2002  
Site Area: 3.05 acres

### CURRENT CONDITIONS

Students in 2022-23 School Year: 250  
Building Area: 30,656 sq. ft.  
Permanent Classrooms: 17  
Portable Classrooms: 2  
Student Capacity: 380

### MASTER PLAN

Projected Students in 2029-30: 250  
Planned Classrooms: 17  
Planned Student Capacity: 340



v2.0 Draft for Board Approval: December 13, 2023

# RIDGWAY HIGH SCHOOL

**SCHOOL CAPACITY**

2022-2023 ENROLLMENT: 250  
 2029-30 PROJECTED ENROLLMENT: 250  
 EXISTING: 380  
 PROPOSED: 340



**> RIDGWAY HIGH SCHOOL**

> SANTA ROSA CITY SCHOOLS DISTRICT | FACILITIES MASTER PLAN | 2177.00

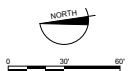

## SCHOOL DATA

Address: 1235 Mendocino Ave  
Santa Rosa, CA 95401

Established: 1924 at current location  
Site Area: 36.86 acres

### CURRENT CONDITIONS

Students in 2025-26 School Year: 2005  
Building Area: 243,589 sq. ft.  
Permanent Classrooms: 73  
Portable Classrooms: 20  
Student Capacity: 2,344

### MASTER PLAN

2030 Enrollment: 1,674  
2035 Enrollment: 1,693  
Planned Classrooms: 78  
Planned Student Capacity: 2,020



V3.0 Draft for Board Approval: February 25, 2026

# SANTA ROSA JUNIOR & SENIOR HIGH SCHOOL

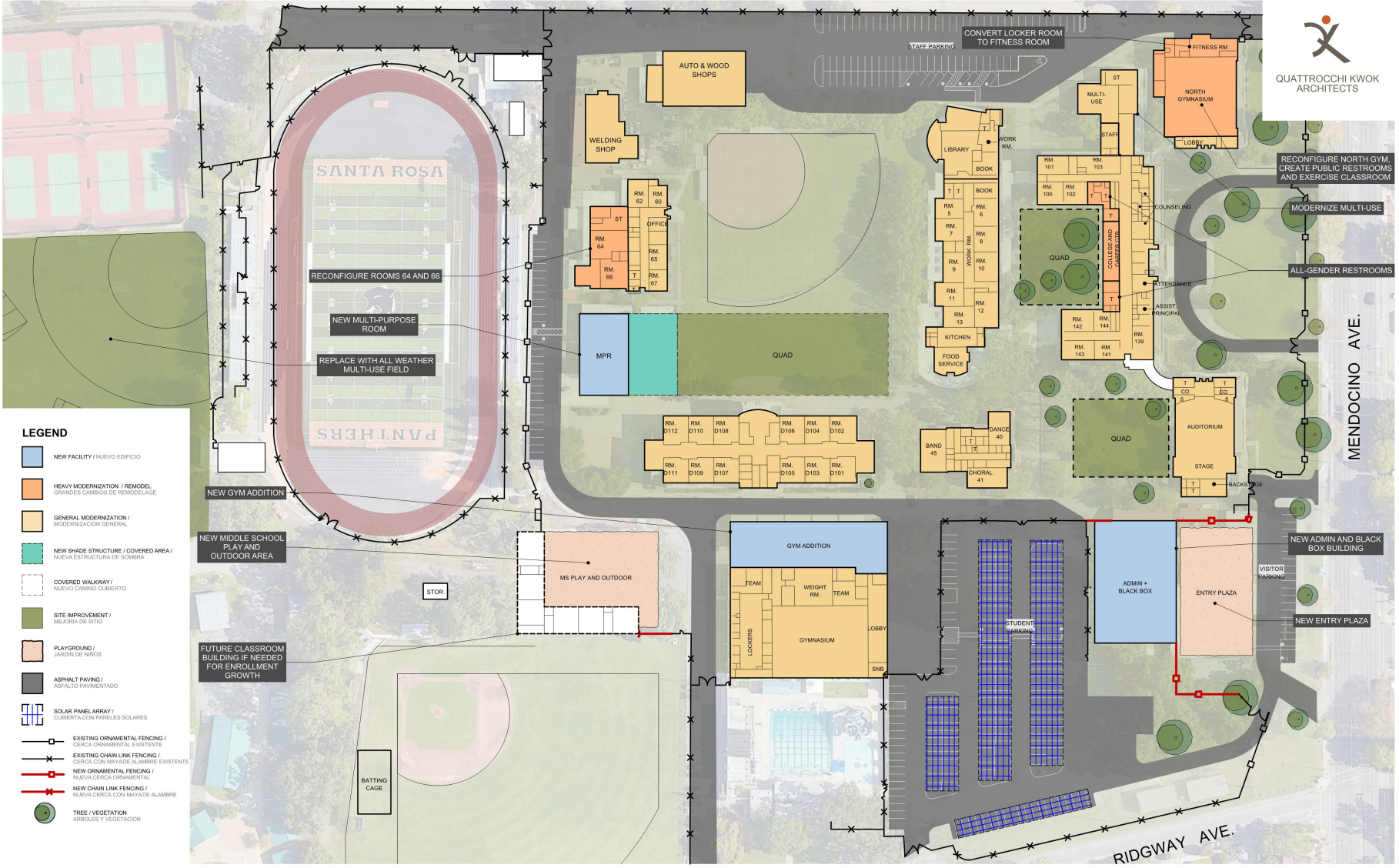

# > SANTA ROSA HIGH SCHOOL

> SANTA ROSA CITY SCHOOLS DISTRICT | FACILITIES MASTER PLAN | 2431.00

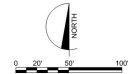

# Facilities Master Planning

This process is **inquiry and data driven** and supports a goal of producing high quality facilities for high quality education.

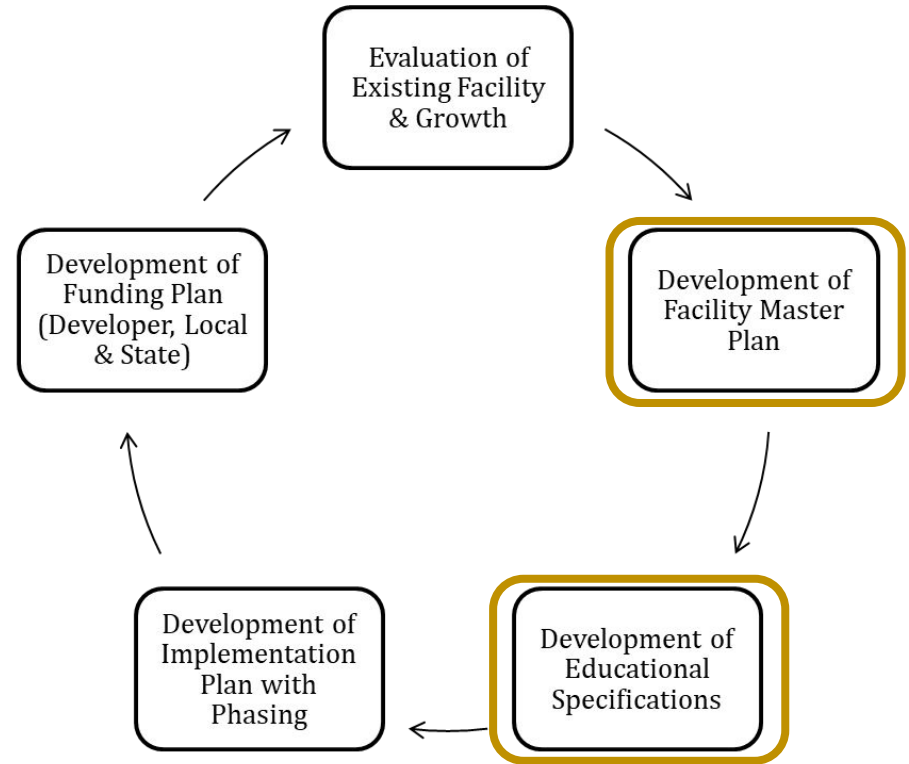

# Implementation Planning

- Process
- Campus Plan Pages
- Bond Program Schedule
- Delivery Methods
- Community Engagement
- Bond Program Cash Flow
- State Funding Plan
- Implementation Plan Funding
- Program & Construction Management Plan

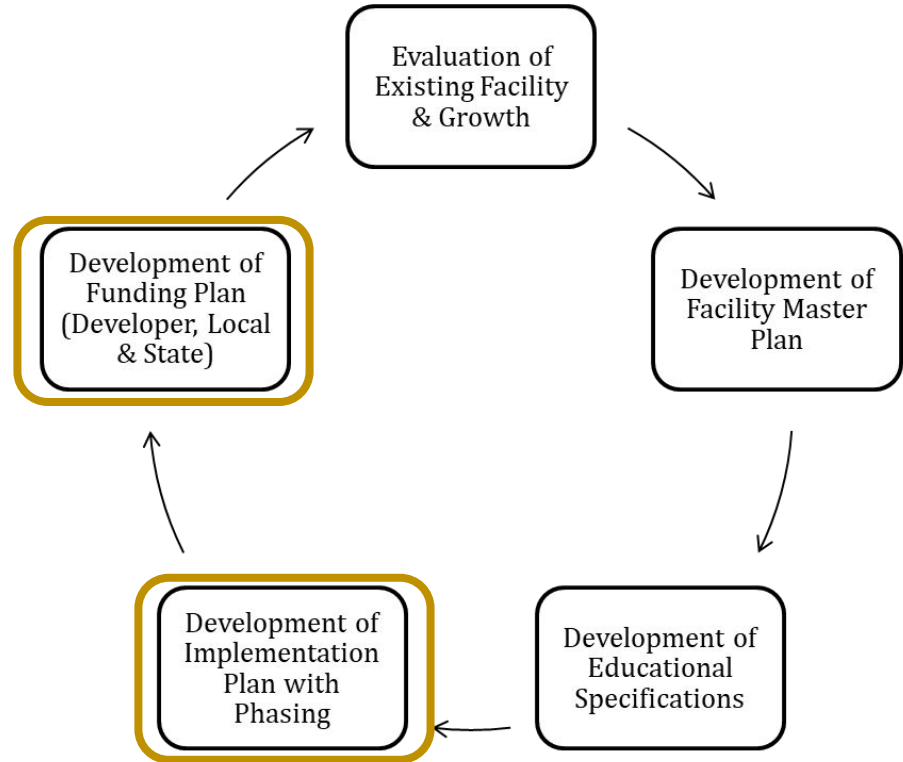

Measure C (\$200M)	Interest	\$5,850,000	Remaining Bond Funds: <b>-\$52,945,000</b>		
Measure G (\$60M)	2.25%		Total Measure G:	\$72,220,000	
\$260,000,000	\$265,850,000		Total Measure C:	\$246,575,000	
Site	Site Type	Project	FMP IOQ Score	Measure	Implementation Cost
Abraham Lincoln	Elementary	Tk/K Building	NA	G	
Abraham Lincoln	Elementary	Fencing	NA	G	\$390,000
Abraham Lincoln	Elementary	Shade Structure	NA	G	\$650,000
Abraham Lincoln	Elementary	Play Structure	NA	G	\$390,000
Abraham Lincoln	Elementary	Classroom Modernization	NA	G	\$850,000
Helen Lehman	Elementary	Classroom Building	NA	G	\$7,800,000
Helen Lehman	Elementary	Admin Reconfiguration	NA	G	\$3,250,000
Helen Lehman	Elementary	Classroom Modernization	NA	G	\$750,000
Helen Lehman	Elementary	MPR	NA	G	
Hidden Valley	Elementary	TK/K Building	NA	G	
Hidden Valley	Elementary	Classroom/Admin Building	NA	G	\$19,500,000
Hidden Valley	Elementary	Classroom Modernization	NA	G	\$1,200,000
Hidden Valley	Elementary	Fencing	NA	G	\$650,000
Hidden Valley	Elementary	Access Control	NA	G	\$1,300,000
Hidden Valley	Elementary	Roofing/HVAC	NA	G	\$5,850,000
James Monroe	Elementary	Admin Reconfiguration	NA	G	
James Monroe	Elementary	Classroom Modernization	NA	G	\$650,000
Luther Burbank	Elementary	TK/K Building	NA	G	\$9,100,000
Luther Burbank	Elementary	Admin Reconfiguration	NA	G	\$5,850,000
Luther Burbank	Elementary	Classroom Modernization	NA	G	\$800,000
Luther Burbank	Elementary	Fencing	NA	G	\$390,000
Luther Burbank	Elementary	Shade Structure	NA	G	\$650,000
Arts Charter	Charter	Roofing (Kinder Bldg only)	NA	G	\$1,300,000
Arts Charter	Charter	Fencing	NA	G	\$650,000
Cesar Chavez	Charter	TK/K Building	NA	C	\$19,500,000
Cesar Chavez	Charter	Admin Reconfiguration	NA	C	\$6,500,000
Cesar Chavez	Charter	Classroom Modernization	NA	C	\$3,000,000
French American	Charter	Classroom Modernization	NA	C	\$1,500,000
French American	Charter	Fencing	NA	C	\$975,000
Elsie Allen	High	Roofing	NA	C	\$32,500,000
Elsie Allen	High	Turf Field	NA	C	\$1,300,000
Elsie Allen	High	Fencing	NA	C	\$1,950,000
Elsie Allen	High	Access Control	NA	C	\$5,200,000
Elsie Allen	High	Classroom Modernization	NA	C	\$8,500,000
Elsie Allen	High	All-Access Restrooms	NA	C	
Maria Carrillo	High	Turf Field	NA	C	\$1,300,000
Maria Carrillo	High	Roofing	NA	C	\$28,600,000
Maria Carrillo	High	Classroom Modernization	NA	C	\$11,700,000
Maria Carrillo	High	All-Access Restrooms	NA	C	
Montgomery	High	Turf Field	NA	C	\$1,300,000
Montgomery	High	Classroom Modernization	NA	C	\$9,100,000
Montgomery	High	New Main Gym	NA	C	\$49,400,000
Montgomery	High	All-Access Restrooms	NA	C	
Piner	High	Turf Field	NA	C	\$1,300,000
Piner	High	Gym Lobby	NA	C	\$6,500,000
Piner	High	Classroom Modernization	NA	C	\$3,000,000
Piner	High	Fencing	NA	C	\$1,950,000
Piner	High	All Access Restrooms	NA	C	
Ridgway	High	Classroom Modernization	NA	C	\$1,500,000
Ridgway	High	New MPR	NA	C	
Santa Rosa	High	Turf Field	NA	C	\$1,300,000
Santa Rosa	High	Girls Locker Room/wrestling rm/multi-use	NA	C	\$10,400,000
Santa Rosa	High	Classroom Modernization	NA	C	\$9,100,000
Santa Rosa	High	New admin/classroom bld.	NA	C	\$18,450,000
Santa Rosa	High	All-Access Restrooms	NA	C	
District Wide	District Wide	Deferred Maintenance	NA	C	\$10,000,000
District Wide	District Wide	Deferred Maintenance	NA	G	\$10,000,000
District Wide	District Wide	CNS- Steam Kettle Project	NA	C	\$750,000
District Wide	District Wide	CNS- Steam Kettle Project	NA	G	\$250,000