



THE INTELLIGENT
Growth Engine

Quote

Amira Q-76490

Prepared For

Dekalb County School District
1701 Mountain Industrial Blvd
ACCOUNTS PAYABLE
Stone Mtn, GA, 30083-1027

Your Amira Partner

Adam Cohn
Account Executive
adam.cohn@amiralearning.com

Quote: Q-76490

Prepared For: Dekalb County School District

Expires On: 8/1/2025

Custom Professional Learning Services

Custom Professional Learning support possibly including on-boarding, agreed upon number of data consultations, and additional assistance as needed by a designated Implementation Specialist for new or continued Istation supporters. Must be used in current subscription term.

QTY	Product	Campus	Start Date	Months	Sales Price
1	Custom Professional Learning Services		8/01/2025	12	\$110,000.00

Start Date: 8/01/2025

Term: 12

End Date: 7/31/2026

List Amount	\$130,000.00
Discount Amount	(\$20,000.00)
Customer Total	\$110,000.00

Please see addendum for price breakdown and professional services being offered.

Addendum

Service	Cost
1. Comprehensive Professional Development Plan a. 30 Full days of on-site Professional Development, with <u>5 days provided at no cost to the district.</u> b. 8 days of Virtual Professional Development.	\$110,000
2. Customer Success Manager	\$0.00
3. Amira training through our Amira Academy, a training sequence providing hours of asynchronous lessons	\$0.00
4. Teacher Resource Hub	
5. Amira Bot and Tech Support	\$0.00



Professional Learning Plan: DeKalb County School District

SY 2025-2026 | Amira ISIP Assess & Tutor Implementation

Scope

- Deliver professional learning for K-3 teachers and administrators who are implementing Amira ISIP Assess & Tutor
 - 20 In-Person Teacher Training Sessions
 - 5 Regional Clusters - Covering all elementary schools
 - 8 Virtual Office Hours/Coaching for Teachers (Monthly)
 - 10 In-Person Admin Training Sessions
-

Professional Learning Delivery Structure

A. Teacher-Focused Onsite Trainings (20 In-Person Sessions)

Model: Regional Clusters across 5 geographic areas (4 In-Person sessions per area)

Cadence: Staggered across the school year to match instructional phases

Time of Year	Training Focus
August / Back-to-School	Meet Amira: Administering ISIP Assessments, Introducing Amira Tutor to Students, Classroom Setup & Routines, Teacher Dashboard Overview
October / Early Fall	Analyzing Beginning-of-Year Data, Setting Usage Goals, Building Effective Practice Routines, Differentiation Strategies with Amira Tutor
January / Mid-Year	Interpreting Mid-Year Assessment Data, Progress Monitoring, Targeting Instructional Gaps, Maximizing Amira's Intervention Features
March-April / Spring Prep	Preparing for End-of-Year Assessments, Sustaining Growth with At-Risk Students, Leveraging Reports for Instructional Planning

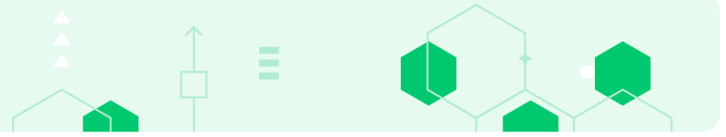

B. Administrator/District Leadership Onsite Trainings (10 Days Total)

Date	Audience		Training Session Notes
7/21	MTSS Specialists	~90 participants	Meet Amira ISIP Assess & Tutor Training
7/29	Teachers	4 Virtual Sessions (Area 1-4 + Specialty)	Meet Amira ISIP Assess & Tutor Training
8/12	Test Coordinators	~100 participants	Amira ISIP Assess Administration
TBD	Academic Coaches & ELA Content Leads	Maximize hybrid days to serve multiple groups	Meet Amira ISIP Assess & Tutor Training
TBD	Remaining 5 Dates	Staggered through year	Topics to Cover: Progress monitoring, data dives, leadership coaching

C. Virtual Coaching / Office Hours

- **Cadence:** Monthly (8 sessions total)
- **Format:** 15-minute microlearning + 15-minute open Q&A
- **Topics:** Rotating based on implementation phase, teacher feedback, and data trends (Topics to be developed in collaboration with the District Team)
- **Timing:** Afternoons to accommodate teacher schedules

Professional Learning Session Objectives

- Understand and confidently administer the Amira ISIP Assessments
- Build routines and classroom structures for ongoing Amira Tutor practice
- Analyze Growth Dashboard data to inform instruction
- Differentiate support using Tutor Settings (Early Reader Scaffold, Spanish Tutoring, Bilingual Options)
- Troubleshoot classroom setup and technology optimizations
- Build student agency and confidence with Amira routines
- Leverage Teacher Resource Hub and Help Tools
- Integrate Science of Reading principles into daily Amira usage

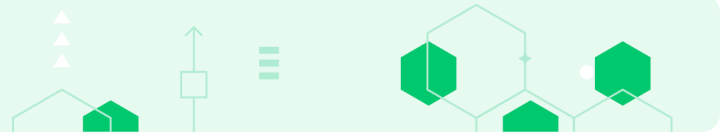

Goals & Success Metrics (To Be Finalized with District Team)

- **Student Usage Goal:** 30+ minutes/week average Amira Tutor usage across all campuses
- **Assessment Participation Goal:** 95% assessment completion for all benchmark windows
- **Growth Goal:** Demonstrated fluency growth per district KPIs
- **Teacher Participation Goal:** 90% attendance at onsite and virtual PD sessions
- **Satisfaction Goal:** 90% positive feedback on PD sessions

Additional Support

- Dedicated Customer Success Manager
- Monthly District Implementation Team Check-Ins
- Champions Network (school-based power users and early adopters)
- Ongoing access to asynchronous courses and on-demand help resources

Customer Success Manager



Amira Customer Success Onboarding Supports



Leader Planning

Overview of onboarding phases, outline goals, schedule trainings, & configurations for sites.

For District implementation team



Rostering & Tech Support

Instructions and support for IT Leadership to ensure rostering occurs and Amira is ready to launch on district devices.

For IT leadership



Site Champions Pathway

Asynchronous courses or live meetings that equip site level "Amira experts" with resources that drive student reading performance with Amira.

For one leader per school (ideally instructional coach, principal, or AP)



Initial Teacher Training

Live online or asynchronous course providing teachers with everything they need to get started with Amira in their classrooms.

For teachers and instructors



Launch Check-In

Opportunity for district leadership and/or site champions to address any questions after initial launch.

For District implementation team + site champions



Data Workshop

Asynchronous workshop that supports teachers to dig into reports and utilize Amira data to inform instruction.

For teachers and instructors



District Data Meetings

Live online or asynchronous meeting with district leadership to reflect on usage and growth data in relation to implementation goals.

For District implementation team

Supporting Teachers

Training Support

Essentials Training: 5 virtual, live sessions
Getting Started, Data & Reporting, Teacher Check-ins

Asynchronous Courses
Flexible, self-paced learning for busy educators

National Webinars
Ongoing learning with experts and peers

Teacher Resource Hub
Guides, best practices, and tools

Amira Bot & Tech Support
On-demand and live support

Site Champions & Teacher Community
Empowering internal leaders to drive success

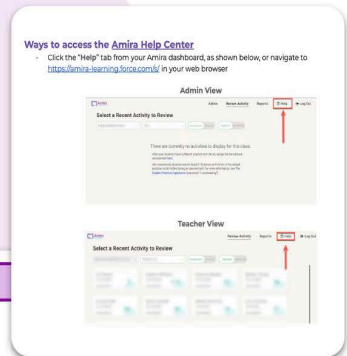
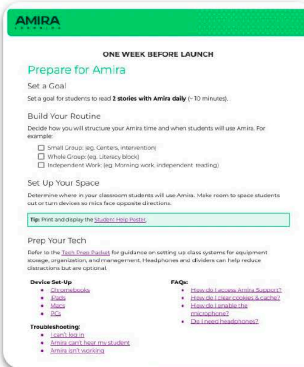

Technology Troubleshooting

<p>Set Up Devices:</p> <ul style="list-style-type: none"> • Chromebooks • iPads • Macs • PCs 	<p>Troubleshooting:</p> <ul style="list-style-type: none"> • I can't log in • Amira can't hear my student • Amira isn't working <p>Download our Help With Amira Guide for more!</p>	<p>FAQs:</p> <ul style="list-style-type: none"> • How do I access Amira Support? • How do I clear cookies & cache? • How do I enable the microphone? • Do I need headphones?
<p>Need help? We got you! Chat with Amira Support or email support@amiralearning.com</p>		

Important Update

Amira Academy courses will be updated to reflect platform enhancements for the 25-26 school year.

Certificates from completed courses will remain accessible, but **"in progress" courses must be finished before June 30, 2025.**

Questions? Email support@amiralearning.com

- My Courses**
Enrolled Courses
- Catalog**
All Amira Courses
- Resources**
Teacher Resource Hub
- Amira Support**
Support Center
- Certificates**
View Transcript

Featured Courses

<p>Meet Amira Online Course ★★★★★ (60) Completed</p>	<p>Amira Advanced Online Course ★★★★★ (2) Enroll</p>	<p>Data Dive Online Course ★★★★★ (5) Completed</p>	<p>Amira Certified Educator Online Course ★★★★★ (10) Completed</p>	<p>Amira Champions Online Course - 45m ★★★★★ (19) Completed</p>
---	---	---	---	--

CATALOG



Search in Catalog

 Subcategories

Filter by
 Course type | Language | States | Tags

Sort by | View as
 Alphabetical | Grid

14 courses

<p>4-Week Demo Pilot Training Online Course ★★★★★ (2) Enroll</p>	<p>Amira Advanced Online Course ★★★★★ (2) Enroll</p>	<p>Amira Certified Educator Online Course ★★★★★ (10) Completed</p>	<p>Amira Champions Online Course - 45m ★★★★★ (19) Completed</p>	<p>Meet Amira: Assessment Only Online Course ★★★★★ (3) Enroll</p>	<p>Returning Teacher Refresher Online Course ★★★★★ (3) Enroll</p>	<p>Conozca a Amira Online Course ★★★★★ (6) Enroll</p>	<p>Data Dive Online Course ★★★★★ (5) Completed</p>	<p>District Leader Planning Module Online Course Enroll</p>
<p>Meet Amira Online Course ★★★★★ (60) Completed</p>	<p>Meet Amira (Practice Only) Online Course ★★★★★ (13) Enroll</p>	<p>Meet Amira for Kindergarten Online Course ★★★★★ (3) Enroll</p>	<p>School Leader Onboarding Online Course ★★★★★ (3) Enroll</p>	<p>Troubleshooting with Amira Online Course ★★★★★ (1) Enroll</p>				

Teacher Resource Hub

Teacher Resource Hub

Here, I've gathered everything you need to help your students thrive with me—from lesson plans and how-to guides to best practices and more. This is your go-to spot for maximizing our time together. I'm here to support you every step of the way as you bring my program to life in your classroom!

Let's get this reading party started!



GETTING STARTED

Essential resources and guides to help you seamlessly **introduce** and **implement** Amira in your classroom.

- Slide Decks
- Lesson Plans
- Implementation Guides
- Helpful Tips and Tricks
- Training Courses



STUDENT RESOURCES

Classroom resources, spanning **goal-setting**, **progress tracking** and **reflective** exercises, all tailored to enhance your Amira experience.

- Goal-Setting Materials
- Progress Trackers
- Reading Logs
- Reflection Templates
- Seasonal Resources



Meet Amira Course



Implementation Guide



Amira Overview One-Pager



Teacher Checklist (Launching Amira)

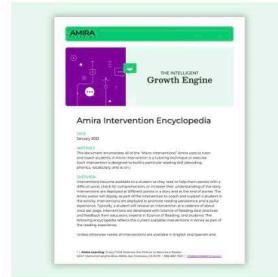

Intervention Encyclopedia
Explains all of the "Micro-Interventions" Amira uses to tutor and coach students.



Tech Care Contract
+ ESPAÑOL
Editable contract to hold students accountable for device care.

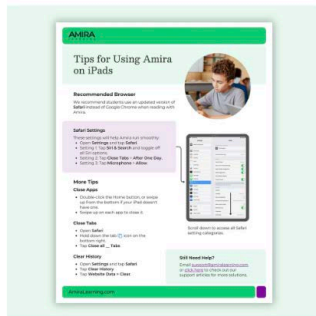

Tips for Using Amira on iPads

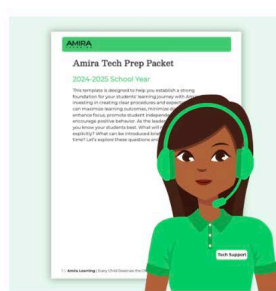

Tech Prep Packet
Editable PDF



Tech Care Family Letter
+ ESPAÑOL

PROFESSIONAL LEARNING

Supercharge Program Success with Amira AI + Expert Professional Learning

Unlock the full potential of the world's most advanced AI reading tutor.

Amira is leading a revolution in literacy through the power of AI. We are transforming how children learn to read by providing the world's most advanced AI-powered literacy tool. But technology alone isn't enough—teachers and administrators need expert guidance to drive real impact. That's where Amira Professional Learning comes in.



Our Professional Learning & Consulting services empower educators to maximize Amira's potential, accelerating student literacy growth like never before. Districts that invest in premium learning experiences see:



Faster adoption
& seamless
implementation



Higher teacher
confidence &
engagement



Significant gains
in student literacy
growth



How does Amira Professional Services Work?

Essential Training

Amira provides essential training to all districts to ensure launch success. These flexible and accessible learning resources ensure a smooth implementation and help educators get started with confidence.



What's Included:

- ✓ **Amira Academy - Asynchronous Course**
Flexible, self-paced learning for busy educators
- ✓ **Live Training Webinars**
Getting Started, Data & Reporting, Teacher Check-Ins & Ongoing learning with experts and peers.
- ✓ **Amira Bot & Tech Support**
On-demand and live support
- ✓ **Site Champions & Teacher Community**
Empowering leaders to drive success
- ✓ **Teacher Resource Hub**
Guides, best practices, and tools

Professional Learning & Consulting Services

Amira's Premium Professional Learning & Consulting Services elevate implementation success, driving deeper literacy outcomes. These offerings are designed for districts that want to:

- Accelerate student outcomes with evidence-based, high-impact professional learning.
- Build teacher capacity with cutting-edge AI-driven literacy training.
- Customize implementation strategies to fit their district's unique needs.



Amira's Premium Professional Learning & Consulting Services elevate implementation success

Driving deeper literacy outcomes. These offerings are designed for districts that want to:

- Demonstrates best practices in using Amira's AI to its full potential.
- Explains how to use Amira to drive literacy gains.
- Provides hands-on guidance.
- Partners on data and coaching strategies.
- Drives a culture of data driven decision making.



Quote: Q-76490

Prepared For: DeKalb County School District

Expires On: 8/1/2025

Disclaimer: Pricing is as quoted and is subject to change based on any modifications to bundle configurations, enrollment updates, or other adjustments. Additional options are to be paid in full. Totals include applicable taxes, which should be reflected on your Purchase Order (if applicable).

To avoid delays in processing your order, please ensure the following:

- Email your Purchase Order, including the provided quote number, to orders@amiralearning.com.
- Digitally sign the contract provided upon commitment with your Amira partner.

Amira Terms of Use: <https://amiralearning.com/amira-terms>

Amira Privacy Policy: <https://amiralearning.com/amira-privacy>

Istation Terms of Use: <https://amiralearning.com/istation-terms>

Istation Privacy Policy: <https://amiralearning.com/istation-privacy-policy>

Effective June 2024, Istation is a 100% wholly owned subsidiary of Amira Learning, Inc. As part of our integration efforts and to enhance efficiency across our organization, we are integrating our financial and banking structures under a single Federal Employer Identification Number (FEIN).

Effective immediately, all transactions, invoices, and financial documentation should be processed using the following federal employer identification number and banking information:

Federal Employer Identification Number (FEIN): 82-2207220

Banking Information

ACH Payments (preferred):

Bank Name: Western Alliance Bank

ABA Routing Number: 121143260

Bank Address: One East Washington Street Ste 2500 Phoenix, Arizona 85004 U.S.A

Account Name: Amira Learning Inc

Account Number: 8996514912

Beneficiary Address: 5214f Diamond Heights Blvd # 3255 San Francisco, CA 94131

Check Payments:

Amira Learning Inc

PO BOX 92448

Las Vegas, NV 89193-2448

(Note: Please do not send check payments to the beneficiary address noted on the W-9.

Check payments should be sent to Amira Learning, Inc.'s lockbox, which is administered by Western Alliance Bank. This address differs from the one listed on the W-9.)

To assist in updating your records, we have attached the following documents:

- Amira Learning, Inc. Form W-9
- Official Banking Letters confirming our updated banking details

Please update your records to reflect this change and ensure that all future payments and correspondence are directed accordingly.

If you have any questions or require additional information, please do not hesitate to reach out to AccountsReceivable@amiralearning.com.

We appreciate your partnership and cooperation.

Sincerely,

A handwritten signature in cursive script that reads "Monika Flood".

Monika Flood, CFO
Amira Learning, Inc.

Request for Taxpayer Identification Number and Certification

Go to www.irs.gov/FormW9 for instructions and the latest information.

Give form to the
requester. Do not
send to the IRS.

Before you begin. For guidance related to the purpose of Form W-9, see *Purpose of Form*, below.

Print or type. See Specific Instructions on page 3.	1 Name of entity/individual. An entry is required. (For a sole proprietor or disregarded entity, enter the owner's name on line 1, and enter the business/disregarded entity's name on line 2.) Amira Learning, Inc.	
	2 Business name/disregarded entity name, if different from above.	
	3a Check the appropriate box for federal tax classification of the entity/individual whose name is entered on line 1. Check only one of the following seven boxes. <input type="checkbox"/> Individual/sole proprietor <input checked="" type="checkbox"/> C corporation <input type="checkbox"/> S corporation <input type="checkbox"/> Partnership <input type="checkbox"/> Trust/estate <input type="checkbox"/> LLC. Enter the tax classification (C = C corporation, S = S corporation, P = Partnership) _____ Note: Check the "LLC" box above and, in the entry space, enter the appropriate code (C, S, or P) for the tax classification of the LLC, unless it is a disregarded entity. A disregarded entity should instead check the appropriate box for the tax classification of its owner. <input type="checkbox"/> Other (see instructions) _____	
	4 Exemptions (codes apply only to certain entities, not individuals; see instructions on page 3): Exempt payee code (if any) _____ Exemption from Foreign Account Tax Compliance Act (FATCA) reporting code (if any) _____ <i>(Applies to accounts maintained outside the United States.)</i>	
	3b If on line 3a you checked "Partnership" or "Trust/estate," or checked "LLC" and entered "P" as its tax classification, and you are providing this form to a partnership, trust, or estate in which you have an ownership interest, check this box if you have any foreign partners, owners, or beneficiaries. See instructions <input type="checkbox"/>	
	5 Address (number, street, and apt. or suite no.). See instructions. 5214F Diamond Heights Blvd #3255	Requester's name and address (optional)
	6 City, state, and ZIP code San Francisco, CA 94131	
7 List account number(s) here (optional) Remit to: P.O. Box 92448, Las Vegas, NV 89193-2448		

Part I Taxpayer Identification Number (TIN)

Enter your TIN in the appropriate box. The TIN provided must match the name given on line 1 to avoid backup withholding. For individuals, this is generally your social security number (SSN). However, for a resident alien, sole proprietor, or disregarded entity, see the instructions for Part I, later. For other entities, it is your employer identification number (EIN). If you do not have a number, see *How to get a TIN*, later.

Social security number								
			-			-		
or								
Employer identification number								
8	2	-	2	2	0	7	2	0

Note: If the account is in more than one name, see the instructions for line 1. See also *What Name and Number To Give the Requester* for guidelines on whose number to enter.

Part II Certification

Under penalties of perjury, I certify that:

- The number shown on this form is my correct taxpayer identification number (or I am waiting for a number to be issued to me); and
- I am not subject to backup withholding because (a) I am exempt from backup withholding, or (b) I have not been notified by the Internal Revenue Service (IRS) that I am subject to backup withholding as a result of a failure to report all interest or dividends, or (c) the IRS has notified me that I am no longer subject to backup withholding; and
- I am a U.S. citizen or other U.S. person (defined below); and
- The FATCA code(s) entered on this form (if any) indicating that I am exempt from FATCA reporting is correct.

Certification instructions. You must cross out item 2 above if you have been notified by the IRS that you are currently subject to backup withholding because you have failed to report all interest and dividends on your tax return. For real estate transactions, item 2 does not apply. For mortgage interest paid, acquisition or abandonment of secured property, cancellation of debt, contributions to an individual retirement arrangement (IRA), and, generally, payments other than interest and dividends, you are not required to sign the certification, but you must provide your correct TIN. See the instructions for Part II, later.

Sign Here	Signature of U.S. person <i>Monika Flood</i>	Date April 27, 2025
------------------	---	------------------------

General Instructions

Section references are to the Internal Revenue Code unless otherwise noted.

Future developments. For the latest information about developments related to Form W-9 and its instructions, such as legislation enacted after they were published, go to www.irs.gov/FormW9.

What's New

Line 3a has been modified to clarify how a disregarded entity completes this line. An LLC that is a disregarded entity should check the appropriate box for the tax classification of its owner. Otherwise, it should check the "LLC" box and enter its appropriate tax classification.

New line 3b has been added to this form. A flow-through entity is required to complete this line to indicate that it has direct or indirect foreign partners, owners, or beneficiaries when it provides the Form W-9 to another flow-through entity in which it has an ownership interest. This change is intended to provide a flow-through entity with information regarding the status of its indirect foreign partners, owners, or beneficiaries, so that it can satisfy any applicable reporting requirements. For example, a partnership that has any indirect foreign partners may be required to complete Schedules K-2 and K-3. See the Partnership Instructions for Schedules K-2 and K-3 (Form 1065).

Purpose of Form

An individual or entity (Form W-9 requester) who is required to file an information return with the IRS is giving you this form because they

BANK ACCOUNT VERIFICATION LETTER**2/18/2025****RE: Amira Learning Inc**

To Whom It May Concern,

This letter is to inform you that **Amira Learning Inc** has an account with Western Alliance Bank.The routing number: **122105980**Account number: **8996514912**

We are pleased to confirm the account is in good standing and the information below for Incoming Wire Transfer and Incoming ACH Payments:

Beneficiary Bank Information

Bank Name: Western Alliance Bank
SWIFT Code: BBFXUS6S
ABA Routing #: 122105980
Bank Address: One East Washington Street Ste 2500
Phoenix, Arizona 85004 U.S.A

Beneficiary Information

Account Name: **Amira Learning Inc**
Account Number: **8996514912**
Beneficiary Address: **5214f Diamond Heights Blvd # 3255**
San Francisco, CA, 94131

The information is supplied solely for the purposes of reference, without any responsibility on the part of Western Alliance Bank, its agents, representatives, or affiliates for errors or omissions.

Sincerely,



Matthew Benidt

Head of Branch Banking