

# Los Altos School District COMMUNITY SCHOOL

10<sup>th</sup> Site



10<sup>TH</sup> SITE COMMUNITY SCHOOL

UPDATE: FEBRUARY 2022



# Today's agenda

## Project Status

The LASD Board of Trustees (10-4-2022) and the City Council of Mountain View (10-26-2022) agreed on the preferred location for the new Mountain View Park

## Potential school and joint use configurations

- » District priorities
- » Options
- » Discussion

# Agreements with City of Mountain View

## » Open Space Park Property Transfer Agreement

- Provides for a transfer of approximately 2 acres to MV in exchange for \$20M
- General location set

## » Funding and Joint Use Agreement

- Provides for approximately 4 acres of the site for joint use (school use during the day and community use after school hours)
- Joint use recreational facilities include athletic fields (track, soccer, baseball fields) and may also include playground facilities, outdoor basketball courts, and other outdoor areas
- A gymnasium is also included as a joint use facility
- City contributed \$23M toward site purchase in exchange for joint use

# Developing a site master plan

- » **The site is approximately 11.5 acres and must accommodate 3 major elements that may adapt and change over time**
  - School and joint use buildings
  - Outdoor recreational space
  - 2 acre park
- » **The site access also needs to provide safe routes to school, safe access for neighbors and efficient operations both during the school day and during non-school hours**

# School and recreational space criteria

- » Safe and secure during school hours
- » Safe routes for student cyclists and pedestrians
- » Safe parent drop-off, pick-up and queue area with limited impact on surrounding area
- » School building, field, and blacktop uninterrupted by traffic or parking
- » Dimensions that allow appropriate campus, field and black top sizes, shapes, and adjacency

# School Considerations

- » The school site needs to preserve flexibility for housing a variety of programs as LASD enrollment and educational approaches change
  - A two-story building design frees up significant space for outdoor recreational spaces (*blacktop activities, PE and field sport activities, possible garden area, K play area*)
  - Preliminary design could accommodate 600-900 students in various configurations (*pre and or TK - 5, 6, or 8; 6-8, or 7-8*)



# Major site elements

**School buildings:**  
• need approx. 2 acres

2 acres



**School/community recreational space:**  
• need approx. 4 acres

4 acres



**City park:**  
• need 2 acres

2 acres



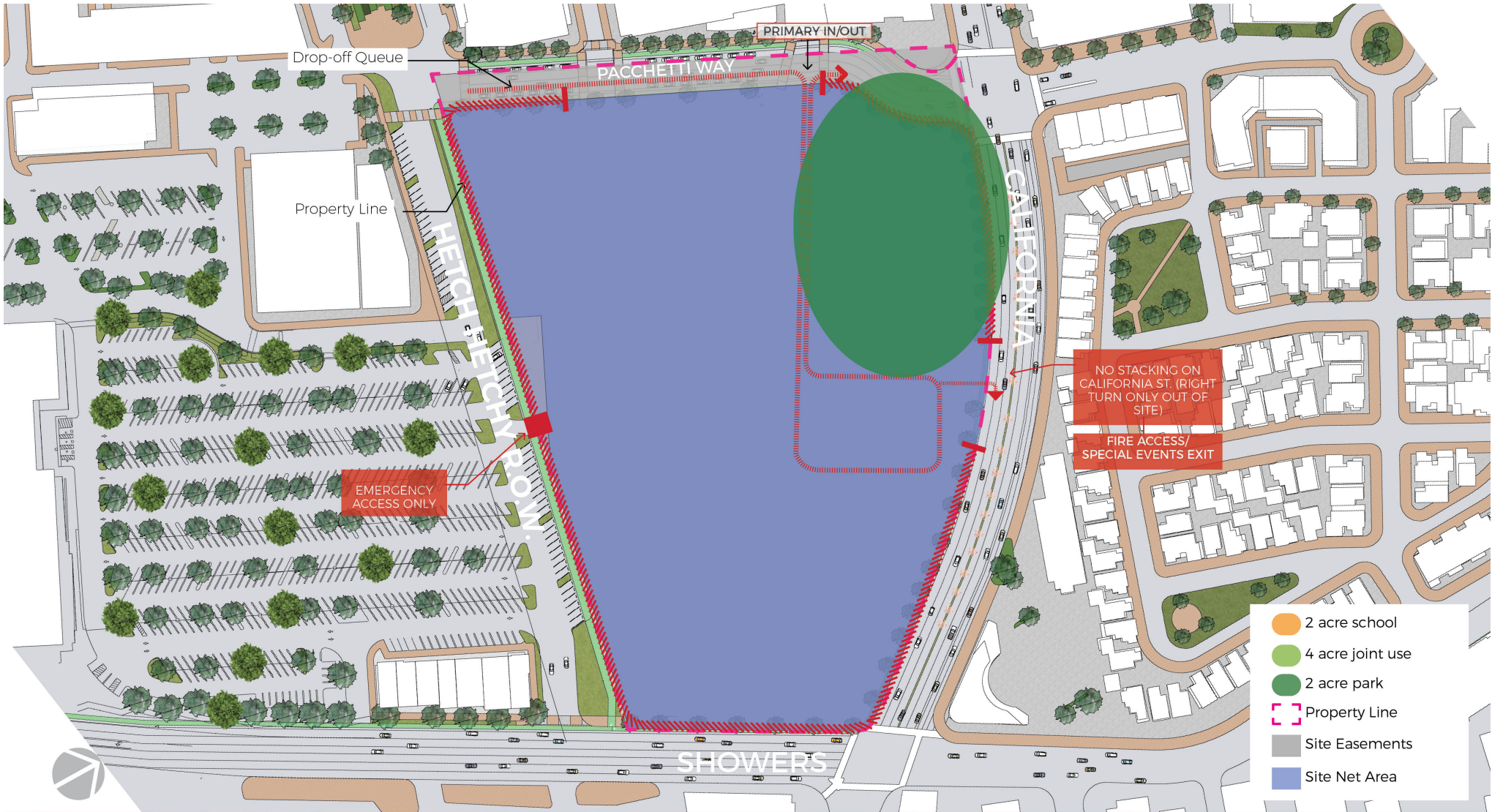

# MOUNTAIN VIEW PARK

UPDATE: FEBRUARY 2022

10<sup>TH</sup> SITE COMMUNITY SCHOOL





10<sup>TH</sup> SITE COMMUNITY SCHOOL

UPDATE: FEBRUARY 2022

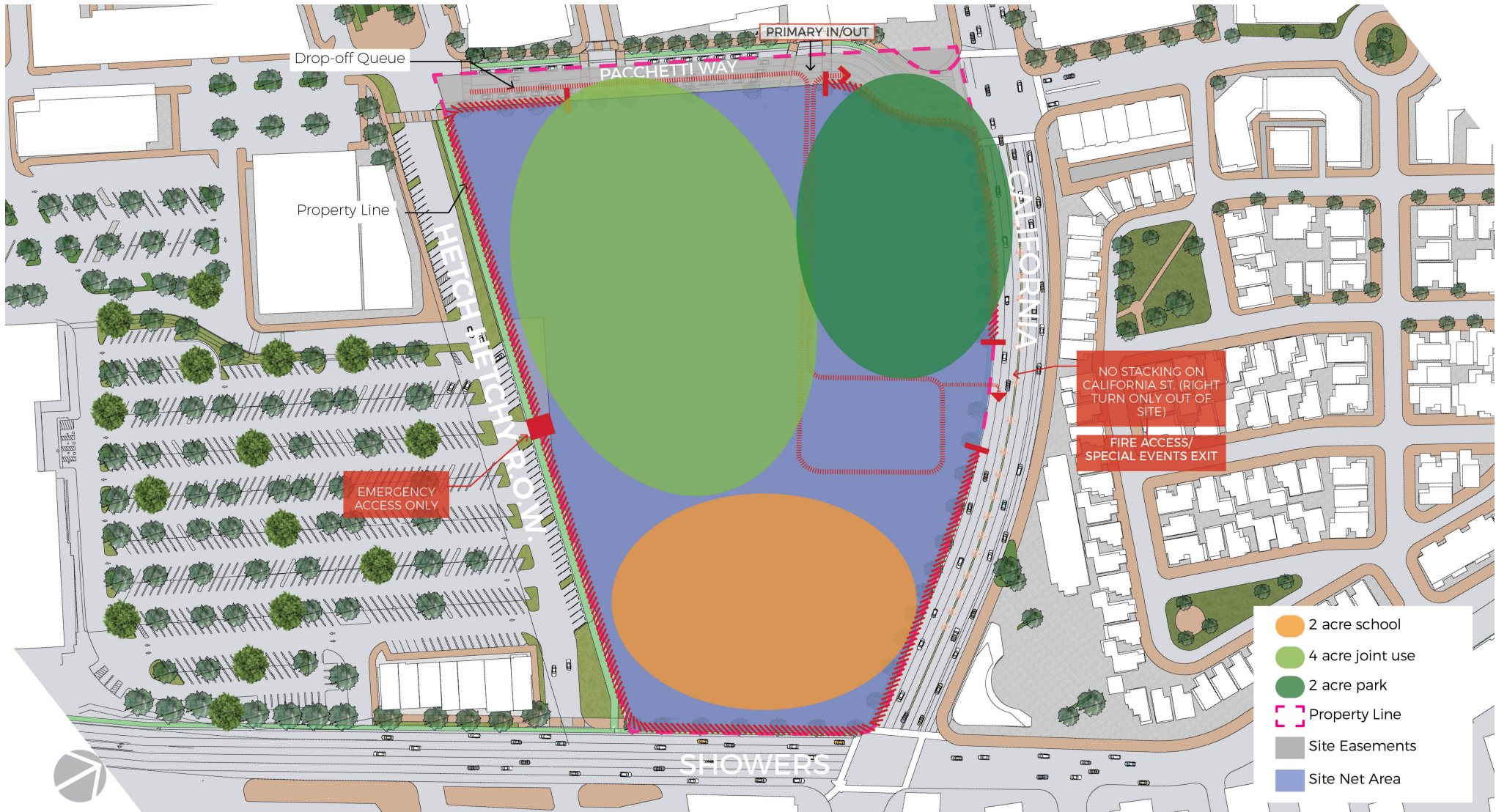

10<sup>TH</sup> SITE COMMUNITY SCHOOL

UPDATE: FEBRUARY 2022

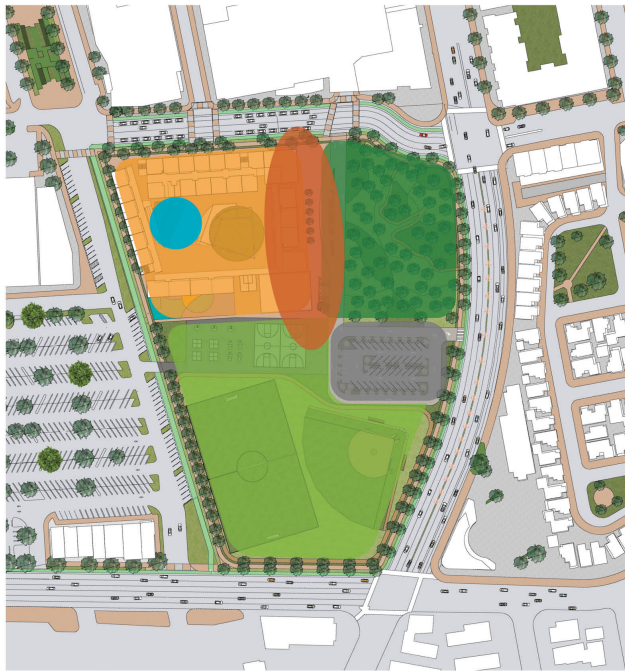

LAYOUT SCENARIO A



LAYOUT SCENARIO B

- 900 STUDENTS
- 2 ACRE SCHOOL
- BUILDING ASSEMBLY SPACES
- 4 ACRE JOINT USE
- 2 ACRE PARK
- PARKING

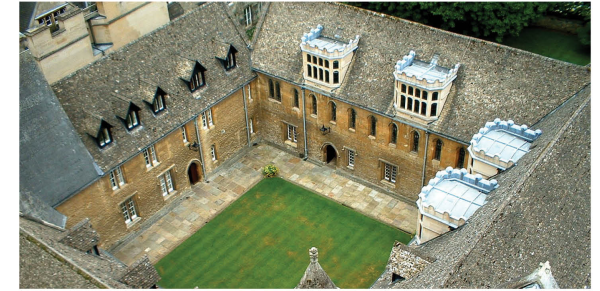

MERTON COLLEGE, OXFORD  
(OLDEST UNIVERSITY QUADRANGLE)



LILIENTHAL ES, SAN FRANCISCO



GREENLEAF TK-8, OAKLAND

# JOINT USE & THE QUADRANGLE CAMPUS TYPE

UPDATE: FEBRUARY 2022

10<sup>TH</sup> SITE COMMUNITY SCHOOL





# LAYOUT SCENARIO A - 900 STUDENTS

UPDATE: FEBRUARY 2022

10<sup>TH</sup> SITE COMMUNITY SCHOOL





# LAYOUT SCENARIO A - 600 STUDENTS

UPDATE: FEBRUARY 2022

10<sup>TH</sup> SITE COMMUNITY SCHOOL





MV PARK @ GROSS 2 ACRE W/ ADJUSTED EASEMENT  
 LAYOUT SCENARIO B - 900 STUDENTS

UPDATE: FEBRUARY 2022

10<sup>TH</sup> SITE COMMUNITY SCHOOL



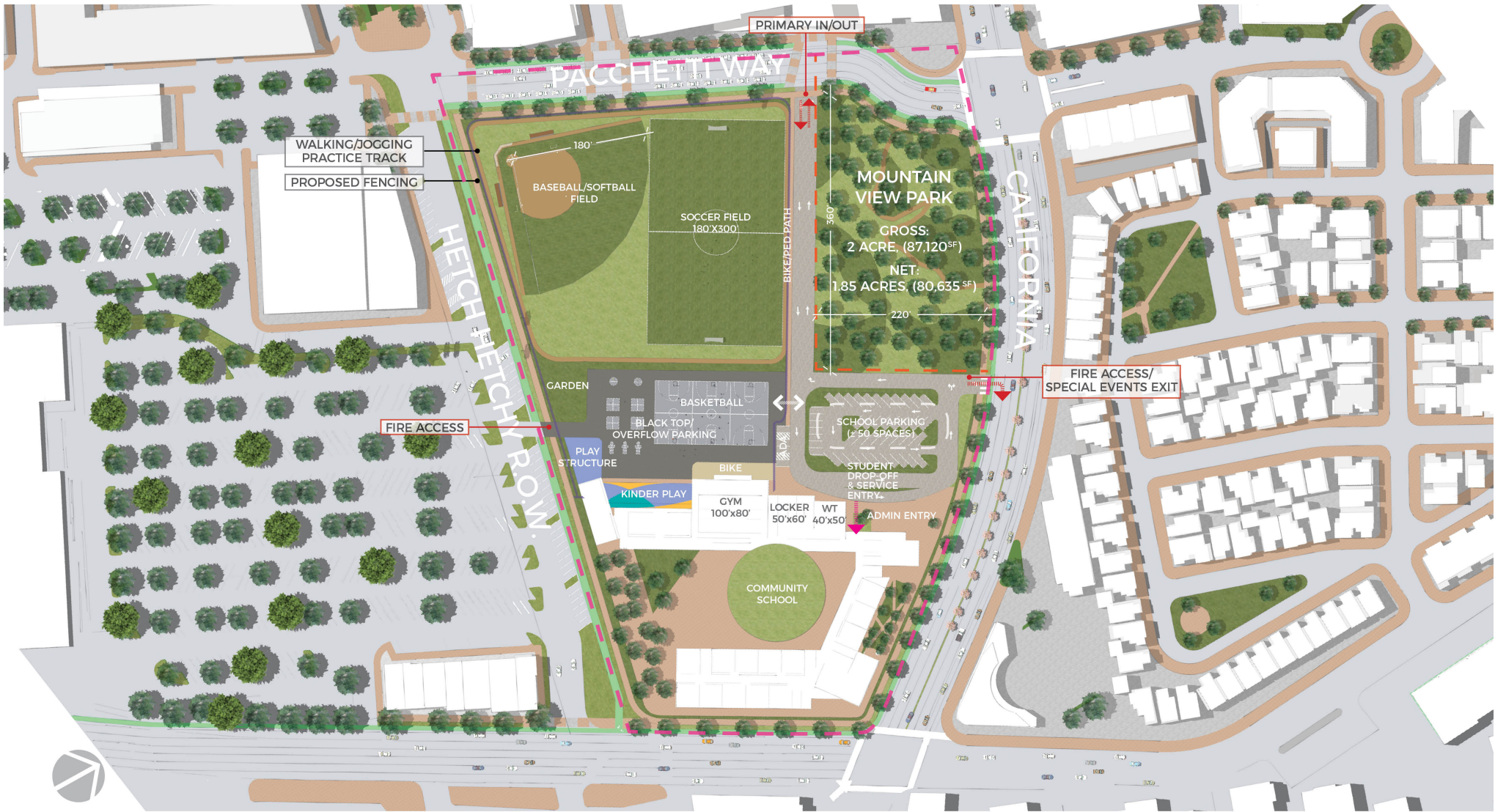

MV PARK @ GROSS 2 ACRE W/ ADJUSTED EASEMENT  
 LAYOUT SCENARIO B - 600 STUDENTS

UPDATE: FEBRUARY 2022

10<sup>TH</sup> SITE COMMUNITY SCHOOL



## APPROACH

## OPPORTUNITY

## CONSTRAINT

A

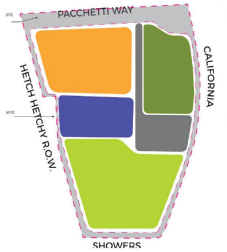

- School site removed from busy streets
- School site accessible to HH greenway pedestrians and bikes
- Park would be nice view from school
- Cruising police would have a clear view of fields

- Athletic fields bordered by busy streets requiring high fencing for balls
- Drop off temptation on Pacchetti requiring ongoing management
- School site relatively invisible
- Park remote from joint use, reducing potential to use together

B

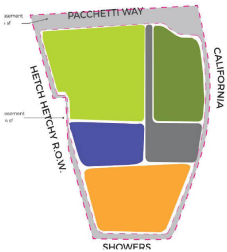

- School site visible at important corner
- On site space for pick up/drop off queue
- Compact field shape
- Fields and park adjacent for possible joint use

- Important to resolve access next to parking for safe bike and pedestrian passage
- School site bordered by busy streets

● 2 ACRE SCHOOL   
 ● BLACK TOP   
 ● 4 ACRE JOINT USE   
 ● 2 ACRE PARK   
 ● PARKING

# OPPORTUNITIES AND CONSTRAINTS

UPDATE: FEBRUARY 2022

10<sup>TH</sup> SITE COMMUNITY SCHOOL



A

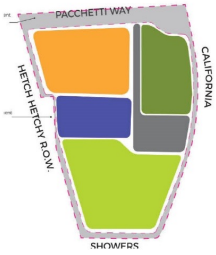

---

---

---

---

---

---

---

---

B

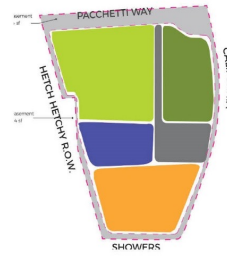

---

---

---

---

---

---

---

---

QUESTIONS ?

UPDATE: FEBRUARY 2022

10<sup>TH</sup> SITE COMMUNITY SCHOOL

