

Santa Rosa City Schools Pilot Classrooms Budget

09/28/2023



SRCS District Furniture Standards – Pilot Classrooms

TLCD Architecture and One Workplace have begun the process of establishing district-wide furniture standards for Santa Rosa City Schools. As a milestone in that process, the team will be designing and implementing pilot classrooms for testing by teachers and students. This opportunity is important to ensure valuable feedback is gained from the end users of the space to inform the most appropriate selections for implementation into the standards package.

The District is planning for five (5) pilot classrooms to be distributed at different grade levels across the district. The teachers and students in those classrooms will put that furniture to the test for a period of two months and provide feedback on the attributes of the items and how well the new furniture supported their classroom needs.

To reach more students, we suggest additional mobile mini-vignettes be implemented in libraries at Elementary, Middle, and High Schools that are not hosting a pilot. These vignettes will be moved from school to school during the two-month pilot testing window to offer greater exposure and feedback from students for furniture selection.

Classrooms Budget	\$ 124,600.59
Optional Mini-Vignettes Budget	\$ <u>15,935.79</u>
Total	\$ 140,536.38

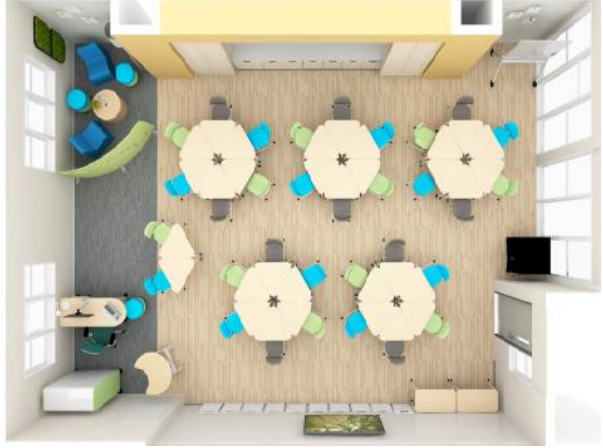

SRCS District Furniture Standards – Pilot Classrooms

The SRCS Furniture Committee and design team reviewed classroom options with associated approximate pilot pricing to determine what to include in the pilot budget (reference following 6 pages).



**Selected
Option**

The pilot budget is based on the
CLASSROOM: ELEMENTARY, 32 STUDENTS option.

This option covers the full suite of general classroom furniture that the actual pilot classrooms might encounter; student desks and seating, lounge furniture, classroom storage and teacher desk and seating.

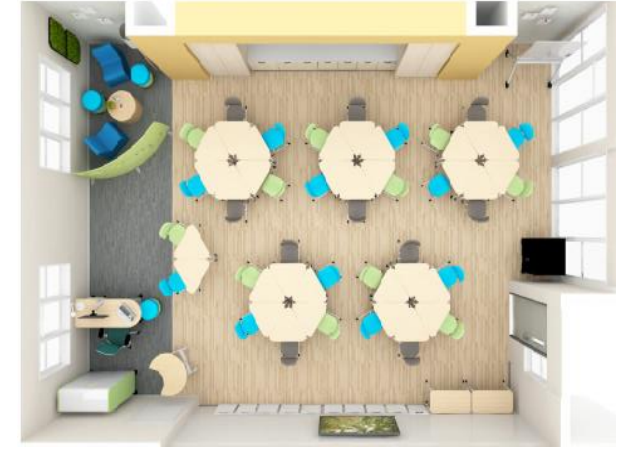

CLASSROOM: TK-KINDER, 24 STUDENTS

Student tables with stack chairs and ottomans. Reading area, carpet area with lounge, teacher desk with worktable and storages.

\$15,350 (excludes tax, freight, and labor)

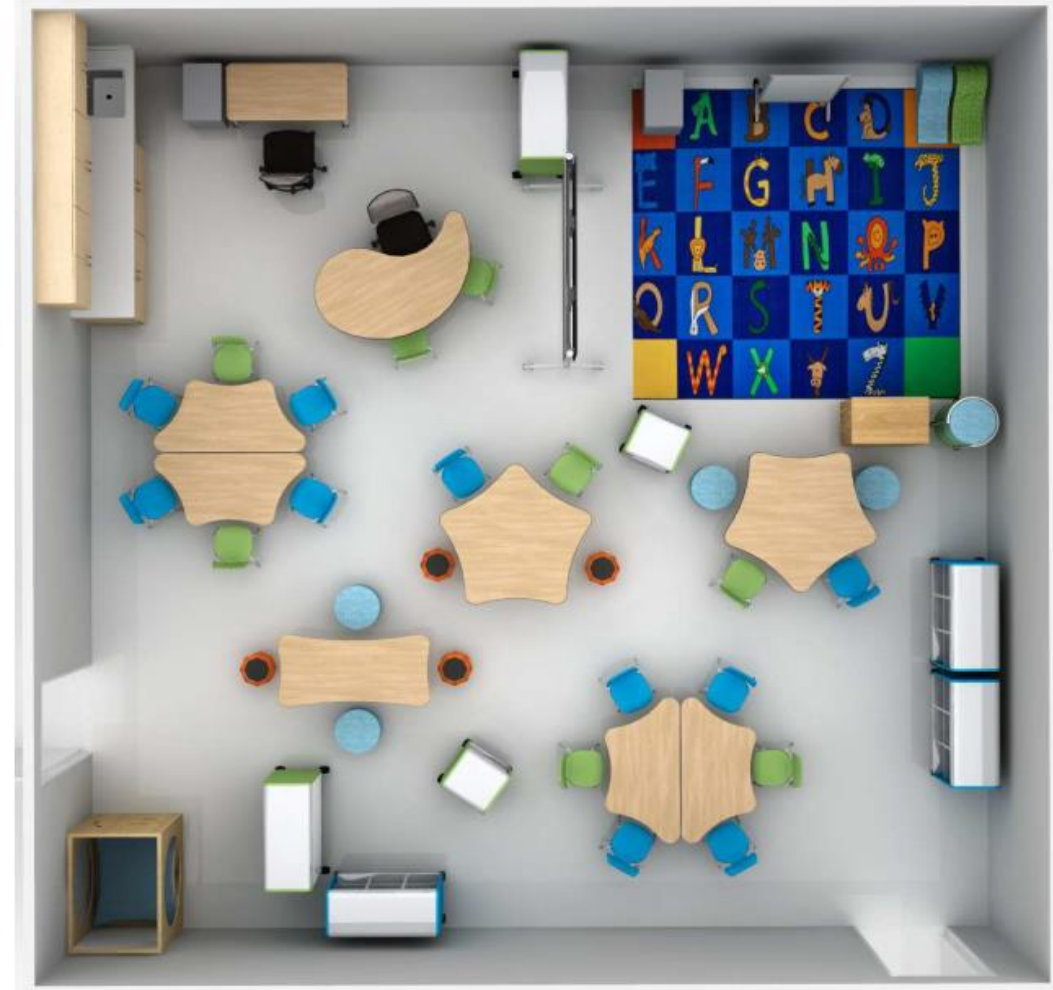
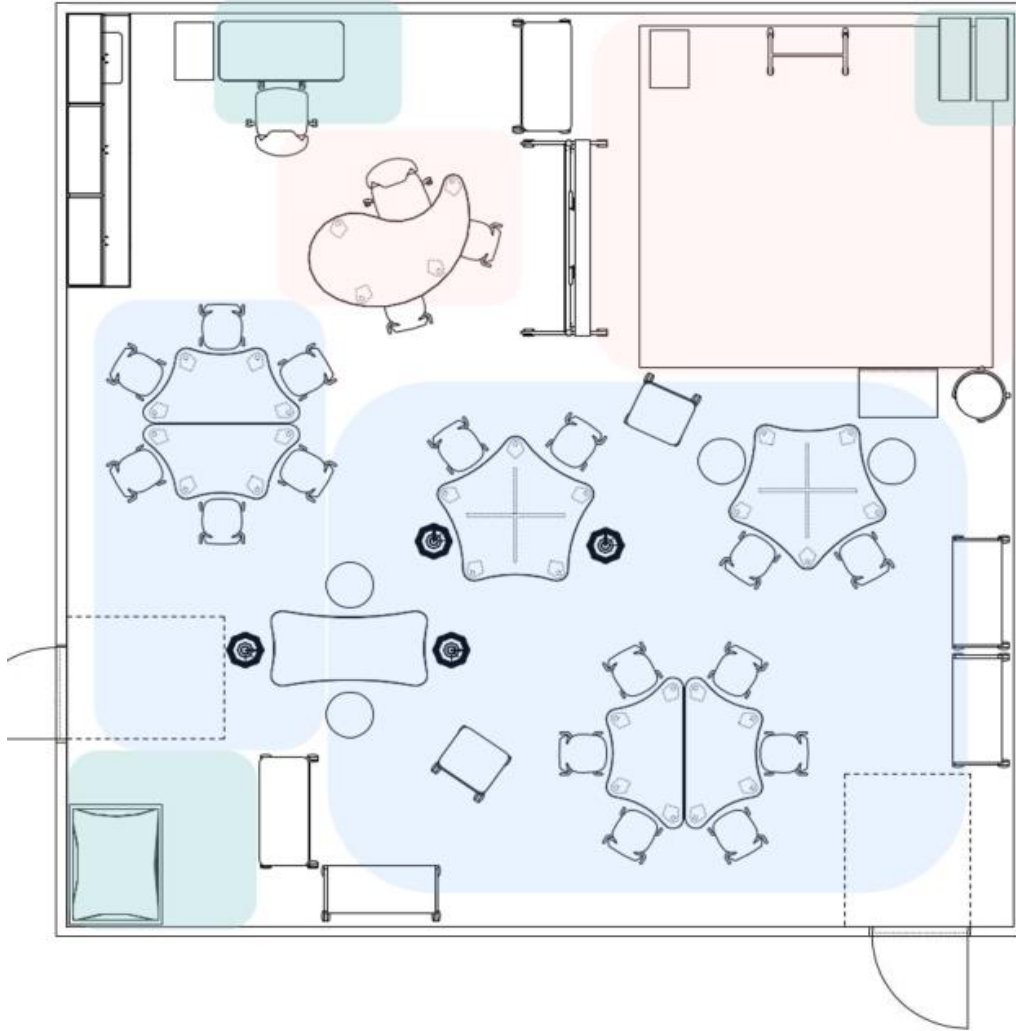

CLASSROOM: ELEMENTARY, 32 STUDENTS

Student desk with cantilever chairs, teacher desk, storage, lounge area
\$12,900 (excludes tax, freight, labor, and white board area)



Selected
Option

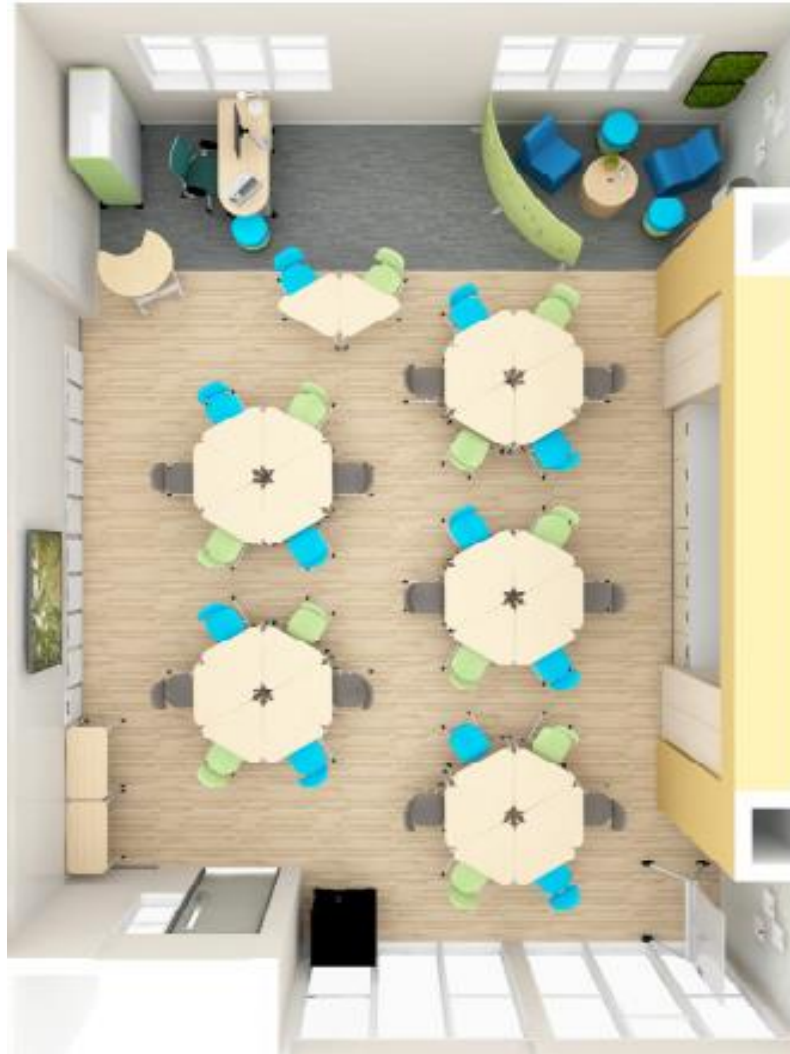

CLASSROOM: ELEMENTARY, 24 STUDENTS

Student desk with cantilever chairs, teacher lectern, storage, lounge area
\$17,000 (excludes, tax, freight and labor)



CLASSROOM: MIDDLE SCHOOL, 30 STUDENTS

Huddle student tables with casters and stack chairs
\$6,800 (excludes tax, freight and labor)

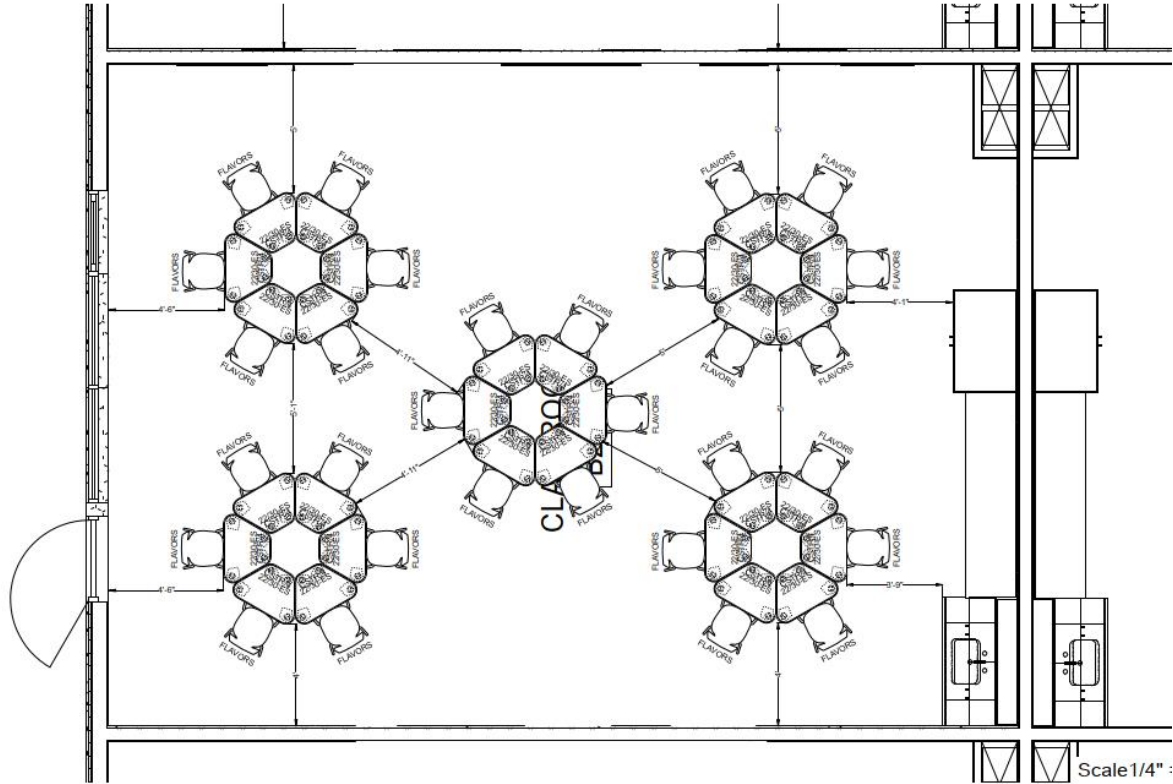

CLASSROOM: HIGHSCHOOL, 24 STUDENTS

Adjustable height nesting tables with stack chairs, lounge seating
\$11,000 (excludes tax, freight and labor)

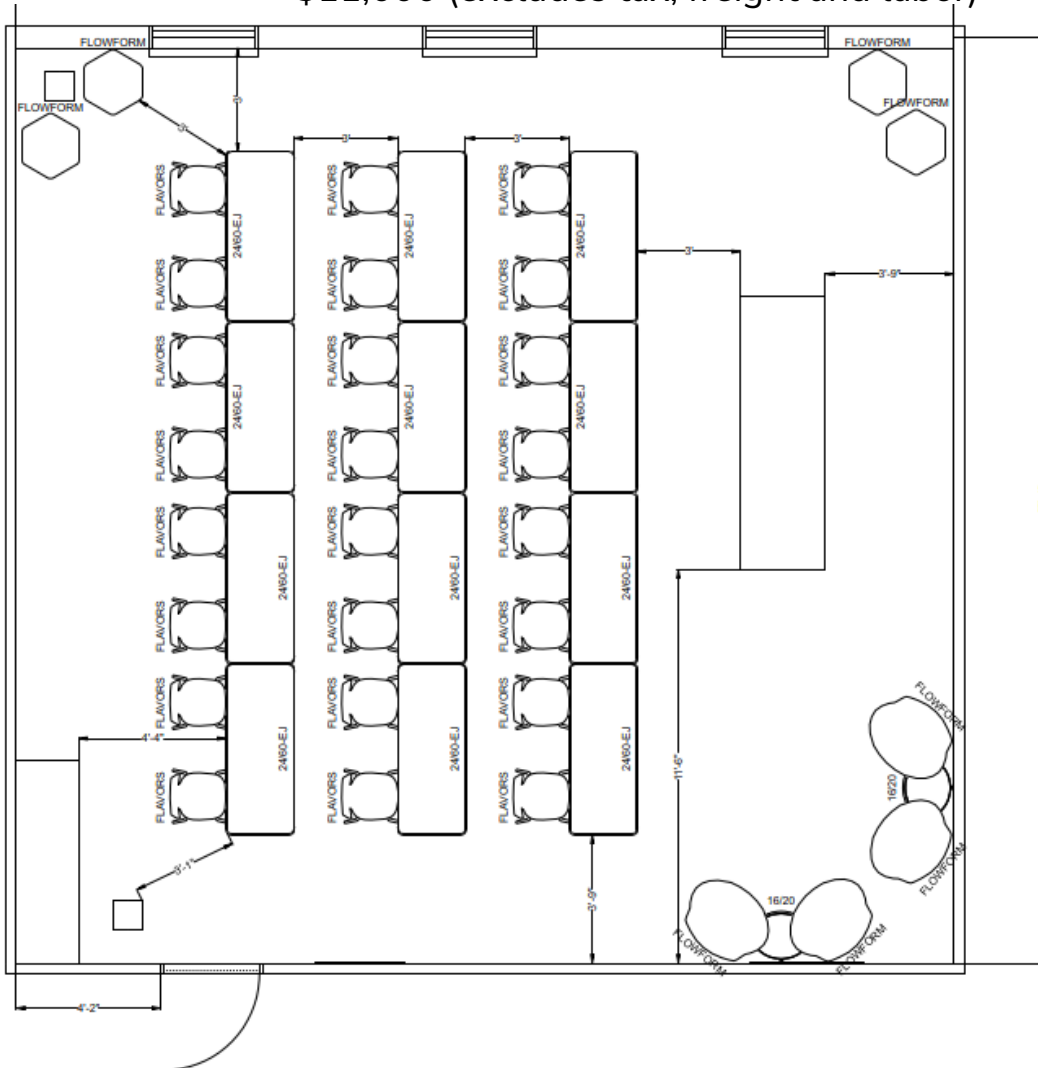

SRCS Furniture Classrooms Pilot Budget

The following quote outlines the full scope of the pilot classroom budget in an itemized list. These items are not final selections but encompass student desks and seating, lounge furniture, classroom storage and teacher desk and seating.

As actual classrooms to host the pilots have not been selected, the budget accounts for the maximum classroom size of 36 students.

This quote accounts for a quantity of 5 pilot classrooms, plus tax, freight and labor installation over a weekend as currently planned in the project schedule.



Headquarters
2500 De La Cruz
Santa Clara, CA 95050
T. 669.800.2300
oneworkplace.com

Quotation 713773

Quote Date 09/21/23

Customer 179074

Terms Net 30

Account Representative Nancy O'Grady

Quote To

Patricia Vasquez
SANTA ROSA CITY SCHOOLS DISTRI
211 RIDGWAY AVE
Santa Rosa CA 95401-4320

Ship To

Patricia Vasquez
SANTA ROSA CITY SCHOOLS DISTRI
211 RIDGWAY AVE
Santa Rosa CA 95401-4320

pvasquez@srcs.k12.ca.us,InvoicesOracle@onewor
kplace.com

pvasquez@srcs.k12.ca.us,InvoicesOracle@onewor
kplace.com

All prices are guaranteed for 30 days from date of quotation unless otherwise specified in a Master Services Agreement (MSA).

Description	Quantity	Unit Price	Extended Price
1 22879 - Numbers Cantilever Chair Size 6 - 18" Frame Finish: Smith System Paint PLT - PLATINUM Shell Finish: Smith System Plastic PLATINUM - PLATINUM Glides: Standard Nylon Base Glide SMITHSYSTE	180T	84.69	15,244.20
2 02133 - Numbers Adjustable Height Student Desk Triangle Leg Finish: Smith System Paint PLT - PLATINUM Worksurface Finish: Smith System Laminate 790960 - FUSION MAPLE LAMINATE Edge Type: F-1 1/4in Top w 3mm Edgbnd Edge Finish: Smith System Plastic MAP - FUSION MAPLE SMITHSYSTE	180T	158.03	28,445.40
3 17576 - 3" Dual Wheel Pack,Dual-Wheel, Set of 4 Locking SMITHSYSTE	135T	37.40	5,049.00
4 02140 - Numbers Adjustable Height 2 Student Desk 24" x 48" Leg Finish: Smith System Paint PLT - PLATINUM Worksurface Finish: Smith System Laminate 790960 - FUSION MAPLE LAMINATE Edge Type: F-1 1/4in Top w 3mm Edgbnd Edge Finish: Smith System Plastic MAP - FUSION MAPLE SMITHSYSTE	10T	210.09	2,100.90
5 911000000 - "CASCADE MEGA-TOWER-OPEN, SHELVES, CSTRS"	5T	595.83	2,979.15

CLIENT SIGNATURE _____

PRINT NAME _____ TITLE _____ DATE _____



SRCS Furniture Classrooms Pilot Budget



Headquarters
2500 De La Cruz
Santa Clara, CA 95050
T. 669.800.2500
oneworkplace.com

Quotation 713773
Page 2 / 5 (cont'd)

Description	Quantity	Unit Price	Extended Price
5 Edge Panel Configuration: P- Pltnm Body w/Solid End Pnls End Panel Finish: Smith System Paint PLT - PLATINUM SMITHSYSTE			
6 910W36000 - "CASCADE MEGA-TOWER-OPEN,36-3""SWTOTES,CSTRS,WB BACK" Edge Panel Configuration: P- Pltnm Body w/Solid End Pnls End Panel Finish: Smith System Paint PLT - PLATINUM SMITHSYSTE Tote: Platinum SMITHSYSTE	5T	1,116.49	5,582.45
7 26160 - "CASCADE TEACHER DESK-SINGL BULLET BBFP(LH)" Laminate Top Finish: Smith System Laminate 790960 - FUSION MAPLE LAMINATE Edge Type: F-1 1/4in Top w 3mm Edgbnd Edge Finish: Smith System Plastic MAP - FUSION MAPLE Frame Finish: Smith System Paint PLT - PLATINUM SMITHSYSTE	5T	515.53	2,577.65
8 01631 - " Silhouette Sit-Stnd Stdnt Dsk, Collab, 21x30" Worksurface Finish: Smith System Laminate 790960 - FUSION MAPLE LAMINATE Edge Type: E -3/4in Top w 3mm Edgbnd Edge Finish: Smith System Plastic MAP - FUSION MAPLE Frame Finish: Smith System Paint PLT - Platinum SMITHSYSTE	5T	283.80	1,419.00
9 OODLE31 - "OODLE STOOL STACK OF 3 W 1 MOVEMENT DISC" Oodle Finish: Smith System Plastic PLATINUM - Platinum SMITHSYSTE	15T	96.07	1,441.05
10 55010 - Flowform Single Seat Surface Finish: Alphabet SAPL - APPLE SMITHSYSTE	10T	478.49	4,784.90
11 55014 - Flowform Flex Screen Leaves Screen Finish: Smith System PET SMGR - MOSS GREEN Foot Finish: Smith System Paint PLT - PLATINUM SMITHSYSTE	5T	788.33	3,941.65
12 56021 - Flowform® Learn Lounge Ottoman + 36" Surface SMITHSYSTE	5T	301.40	1,507.00

CLIENT SIGNATURE _____

PRINT NAME _____ TITLE _____ DATE _____



Headquarters
2500 De La Cruz
Santa Clara, CA 95050
T. 669.800.2500
oneworkplace.com

Quotation 713773
Page 3 / 5 (cont'd)

Description	Quantity	Unit Price	Extended Price
13 70501 - Compass Porcelain Lapboard- 4 pack MOORECO	40T	323.36	12,934.40
14 70505 - Porcelain lapboard - wall mount MOORECO	160T	5.90	944.00
15 2222.B1.F.A129 - Wit Task, Midback, Mesh Back, Standard Synchro, Height/Width Adj Arms Seat Depth Adjustment Option Selection: ~: No Seat Depth Adjustment Upgrade Wit Frame Color Options: FC1: Black Z1: Black ~: Black Arm B0: Standard Black Base S0: Standard Cylinder C17: Hard Floor and Carpet Casters Wit Mesh Back Colors: MC20: Onyx Fabric or Leather Upholstery Selection: FABRIC: Fabric Grade Selections ~: No Selection FG1: Fabric Grade 1 SUGAR: Sugar Color Selection LICORICE: Sugar Licorice Packaging Options: KD: Knocked Down EXEMPLIS	5T	373.40	1,867.00
16 SMPLN25260 - Planner; Studio-Whiteboard, Mobile, Fixed height, With casters, 29H Leg Finish: SMITH SYSTEM PAINT PLT - PLATINUM Whiteboard Type: Laminate SMITHSYSTE	5T	479.96	2,399.80
17 LABOR - Receive and assemble at CPI Warehouse (all furniture with exception to items with minimal assembly) during normal business hours, deliver and place to (5) Pilot Classrooms on OVERTIME at (5) different sites the following furniture. Each classroom consists of the following: (36) desks (36) chairs	1T	20,833.33	20,833.33

CLIENT SIGNATURE _____

PRINT NAME _____ TITLE _____ DATE _____



SRCS Furniture Classrooms Pilot Budget



Headquarters
2500 De La Cruz
Santa Clara, CA 95050
T. 669.800.2500
oneworkplace.com

Quotation 713773
Page 4 / 5 (cont'd)



Headquarters
2500 De La Cruz
Santa Clara, CA 95050
T. 669.800.2500
oneworkplace.com

Quotation 713773
Page 5 / 5 (cont'd)

Description	Quantity	Unit Price	Extended Price
17 (2) lounge chairs (3) ottomans (1) free standing screen (1) side table (1) teacher desk (1) lectern (1) task chair (1) cascade storage unit with doors, mobile (2) 30 x 36 tables: COORDINATE			
Quotation Totals			
Sub Total			114,050.88
Estimated Tax Rate - 9.250%			10,549.71
Grand Total			124,600.59

Select Images are provided as a preliminary color and type representation and should not be used for final color and product selection. Due to individual computer/monitor/printer settings: color, texture, pattern, size and feature rendering may vary from the actual sample. For accuracy, order and view an actual sample.

End of Quotation

1. QUOTATIONS AND ORDERS

TERM: All prices are guaranteed for 30 days from date of quotation.

- a. **PAYMENT TERMS:** Balance is due in full net thirty (30) days from date of invoice. For open punch list items, an amount commensurate to items in question and no greater than 10% may be withheld until completion as per standard industry practice.
- b. **DELAYS:** If, for any reason, Buyer is unable to receive product at the job site on the mutually agreed upon delivery date, product will be deemed delivered and will be invoiced as if delivered
- c. **CANCELLATIONS:**
All product is manufactured to customer specifications and, therefore, cannot be canceled once produced or in production, or returned. Restocking programs are not available.
- d. **EXTRA HANDLING DUE TO SITE CONDITIONS:** Charges will be assessed to the Buyer for excessive handling, storage and transportation incurred because of site conditions, activity of other trades, or other reasons beyond Seller's control not specifically identified in the price quotation at a standard hourly rate or actual charges if performed by a third party.

2. DELIVERY AND INSTALLATION

- a. **SELLER'S RESPONSIBILITIES:** Seller assumes responsibility to receive, inspect, stage, deliver and install Buyer's goods. All furnishings will be clean and put into good working order. Cartoning and packing materials will be removed and premises left in good order. When applicable, Seller may direct shipments directly to the job site.
- b. **FREIGHT CLAIMS:** Claims for product damaged in transit, other than drop shipments, will be processed by Seller and damaged product will be repaired or replaced to the reasonable satisfaction of Buyer.
- c. **WARRANTIES:**
SELLER MAKES NO WARRANTIES OF PRODUCT SOLD HEREUNDER WHATSOEVER, INCLUDING ANY WARRANTY OF MERCHANTABILITY OR WARRANTY THAT THE FURNITURE IS FIT FOR ANY PARTICULAR PURPOSE.

FORCE MAJEURE

Neither Party will be liable for a delay in performing its obligations under this Agreement or any Order to the extent that delay is caused by insurrection, war, terrorism, riot, explosion, nuclear incident, fire, flood, earthquake, or other catastrophic event or Act of God beyond the reasonable control of the affected Party.

These terms apply unless an alternative MSA has been agreed upon.

To view our full Terms and Conditions, visit www.oneworkplace.com/owp_tc

CLIENT SIGNATURE _____

PRINT NAME _____ TITLE _____ DATE _____

CLIENT SIGNATURE _____

PRINT NAME _____ TITLE _____ DATE _____



SRCS District Furniture Standards – Pilot Classrooms

The SRCS Furniture Committee and design team have provided three examples of optional additional mobile mini-vignettes with associated pricing (reference following 3 pages).



OPTIONAL VIGNETTE 1:

4 sets of VS Desk and chairs with 2 Fomcore Lounge chairs
\$3,991.67 (excludes freight and labor)



OPTIONAL VIGNETTE 2:

Norva Nivel Pebble table with rocker ottos and Fomcore Hug Chair
\$4,554.02 (excludes freight and labor)



OPTIONAL VIGNETTE 3:

Smith System Elemental Huddle Desk with Flavors chairs and 2 Flowform lounge chairs.
\$1,848.23 (excludes freight and labor)



SRCS Furniture Mini-Vignette Pilot Budget

The following quote outlines the scope of the optional mini-vignettes budget in an itemized list. These items are not final selections but encompass the variety of furniture we would suggest implementing; student desks and seating and lounge furniture.

This quote accounts for the 3 options pictured, plus tax, freight and labor.



Headquarters
2500 De La Cruz
Santa Clara, CA 95050
T.669.800.2500
oneworkplace.com

Quotation 714297

Quote Date 09/28/23
Customer 179074
Terms Net 30
Account Representative Nancy O'Grady

Quote To

Patricia Vasquez
SANTA ROSA CITY SCHOOLS DISTRI
211 RIDGWAY AVE
Santa Rosa CA 95401-4320

Ship To

Patricia Vasquez
SANTA ROSA CITY SCHOOLS DISTRI
211 RIDGWAY AVE
Santa Rosa CA 95401-4320

pvasquez@srcs.k12.ca.us,InvoicesOracle@oneworkplace.com pvasquez@srcs.k12.ca.us,InvoicesOracle@oneworkplace.com

All prices are guaranteed for 30 days from date of quotation unless otherwise specified in a Master Services Agreement (MSA).

Description	Quantity	Unit Price	Extended Price
Vignette# 1			
1 01440 - Shift+ Base Freeform student table, convex, stackable, 4 leg frame with black end caps and center frame, table top 96.8Wx54/39.1cm VSFURNITUR	2T	340.00	680.00
2 01441 - Shift+ Base Freeform student table, convex, stackable, 4 leg frame with black end caps and center frame, table top 96.8Wx54/39.1cm VSFURNITUR	2T	340.00	680.00
3 31400 - Panto Swing Lupo - Chair with polypropylene seat and backrest shell VSFURNITUR	4T	124.00	496.00
4 FK020-24X30X39.5.G1 - Fom Chair seat height 18" Finish Glide Option FOMCORE	2T	898.85	1,797.70
Sub Total			3,653.70
Estimated Tax Rate - 9.250%			337.97
Total			3,991.67

Vignette# 2

5 10-C0000-28-NW - Pebbletree P01 Collection NonWritable 4x Pebble Tree study tables 32x23x28"H 4x Rocker Ott.10S	1T	3,139.80	3,139.80
--	----	----------	----------

CLIENT SIGNATURE _____

PRINT NAME _____ TITLE _____ DATE _____



SRCS Furniture Mini-Vignette Pilot Budget



Headquarters
2500 De La Cruz
Santa Clara, CA 95050
T. 669.800.2500
oneworkplace.com

Quotation 714297
Page 2 / 4 (cont'd)

Description	Quantity	Unit Price	Extended Price
5 18"x16"18"H NORVANIVEL			
6 F721-29-15X27.5Z - Hug chair, seat height 14"H FOMCORE	2T	514.32	1,028.64
Sub Total			4,168.44
Estimated Tax Rate - 9.250%			385.58
Total			4,554.02
Vignette #3			

Subsection Finish Summary

SAPL SAPL - APPLE

Storage Accessory

462260 462260 - GREY NEBULA
LAMINATE

APL APL - APPLE T MOLD

PLT PLT - PLATINUM

Seating

APPLE APPLE - APPLE

PLT PLT - PLATINUM

7 ELHUDL - "Elemental Huddle Student Desk, 22"D x 32"W" Worksurface Finish: Smith System Laminate 462260 - GREY NEBULA LAMINATE Edge Type: D-1 1/4in Top w 4mm TMld Edge Finish: Smith System T-Mold APL - APPLE T MOLD Leg Finish: Smith System Paint PLT - Platinum Height: ES - Student Desk Leg SMITHSYSTE	4T	125.40	501.60
8 11849 - "Flavors;Stk chair,A shell,18H" Shell Finish: Smith System Plastic APPLE - Apple Frame Finish: Smith System Paint PLT - Platinum Glides: Standard Nylon Base Glide SMITHSYSTE	4T	58.29	233.16
9 55010 - Flowform Single Seat Surface Finish: Alphabet SAPL - APPLE SMITHSYSTE	2T	478.49	956.98

CLIENT SIGNATURE _____

PRINT NAME _____ TITLE _____ DATE _____



Headquarters
2500 De La Cruz
Santa Clara, CA 95050
T. 669.800.2500
oneworkplace.com

Quotation 714297
Page 3 / 4 (cont'd)

Description	Quantity	Unit Price	Extended Price
Sub Total			1,691.74
Estimated Tax Rate - 9.250%			156.49
Total			1,848.23
10 FREIGHT - Freight - Norva Nivel VS America VSFURNITUR	1T	1,666.67	1,666.67
11 LABOR - Labor to receive, deliver and place (3) Vignettes to be delivered to 3 different schools. Labor to be completed during overtime hours. COORDINATE	1T	3,405.99	3,405.99

Quotation Totals

Sub Total	14,586.54
Estimated Tax Rate - 9.250%	1,349.25
Grand Total	15,935.79

Select Images are provided as a preliminary color and type representation and should not be used for final color and product selection.
Due to individual computer/monitor/printer settings: color, texture, pattern, size and feature rendering may vary from the actual sample.
For accuracy, order and view an actual sample.

End of Quotation

CLIENT SIGNATURE _____

PRINT NAME _____ TITLE _____ DATE _____



SRCS Furniture Mini-Vignette Pilot Budget



Headquarters
2500 De La Cruz
Santa Clara, CA 95050
T. 669.800.2500
oneworkplace.com

Quotation 714297
Page 4 / 4 (cont'd)

1. QUOTATIONS AND ORDERS

TERM: All prices are guaranteed for 30 days from date of quotation.

- a. **PAYMENT TERMS:** Balance is due in full net thirty (30) days from date of invoice. For open punch list items, an amount commensurate to items in question and no greater than 10% may be withheld until completion as per standard industry practice.
- b. **DELAYS:** If, for any reason, Buyer is unable to receive product at the job site on the mutually agreed upon delivery date, product will be deemed delivered and will be invoiced as if delivered.
- c. **CANCELLATIONS:**
All product is manufactured to customer specifications and, therefore, cannot be canceled once produced or in production, or returned. Restocking programs are not available.
- d. **EXTRA HANDLING DUE TO SITE CONDITIONS:** Charges will be assessed to the Buyer for excessive handling, storage and transportation incurred because of site conditions, activity of other trades, or other reasons beyond Seller's control not specifically identified in the price quotation at a standard hourly rate or actual charges if performed by a third party.

2. DELIVERY AND INSTALLATION

- a. **SELLER'S RESPONSIBILITIES:** Seller assumes responsibility to receive, inspect, stage, deliver and install Buyer's goods. All furnishings will be clean and put into good working order. Cartoning and packing materials will be removed and premises left in good order. When applicable, Seller may direct shipments directly to the job site.
- b. **FREIGHT CLAIMS:** Claims for product damaged in transit, other than drop shipments, will be processed by Seller and damaged product will be repaired or replaced to the reasonable satisfaction of Buyer.
- c. **WARRANTIES:**

SELLER MAKES NO WARRANTIES OF PRODUCT SOLD HEREUNDER WHATSOEVER, INCLUDING ANY WARRANTY OF MERCHANTABILITY OR WARRANTY THAT THE FURNITURE IS FIT FOR ANY PARTICULAR PURPOSE.

FORCE MAJEURE

Neither Party will be liable for a delay in performing its obligations under this Agreement or any Order to the extent that delay is caused by insurrection, war, terrorism, riot, explosion, nuclear incident, fire, flood, earthquake, or other catastrophic event or Act of God beyond the reasonable control of the affected Party.

These terms apply unless an alternative MSA has been agreed upon.

To view our full Terms and Conditions, visit www.oneworkplace.com/owp_tc

CLIENT SIGNATURE _____

PRINT NAME _____ TITLE _____ DATE _____

