

New Hanover County Schools

Board of Education
May 2, 2023

Strategic Plan
Student Safety: People and Places



CAMPUS SAFETY - PHYSICAL ENVIRONMENT



JANUARY 2023 SAFETY PRESENTATION

- Physical and Operational Safety
- Student Safety and Discipline
- Emergency Operations Plans (EOP)
- School Level Safety Teams
- District Level Safety Teams
- Safety Management Committee
- Safety Practices
- How We Physically Secure Our Campuses
 - School Resource Officers at Each Campus



True North Consulting Group

- Conducted Assessments 2019
 - District-Wide
 - Each Campus
- Established
 - Prioritized Scope of Work
 - Prioritized Sites

District Implementation

- Safety/ Security Scope of Work Prioritized for New School and Renovation Projects
- \$1 Million in Funds Dedicated Annually Beginning Capital Year 2020-21
- North Carolina Center For Safer Schools Safety Grant

New Hanover County Schools



Reach, Equip, Achieve.

Security & Risk Assessment District-Wide Executive Report

July 2019

Prepared for:
New Hanover County Schools

Prepared by:
True North Consulting Group



Let's Visit Our Campuses



What We're Doing to Enhance Security

SAFETY BEGINS BEFORE ENTERING CAMPUS



SITE DESIGN

- Incorporate CPTED Principles
- Control Site Access
- Establish Key Lines of Site
- Create Sense of Ownership

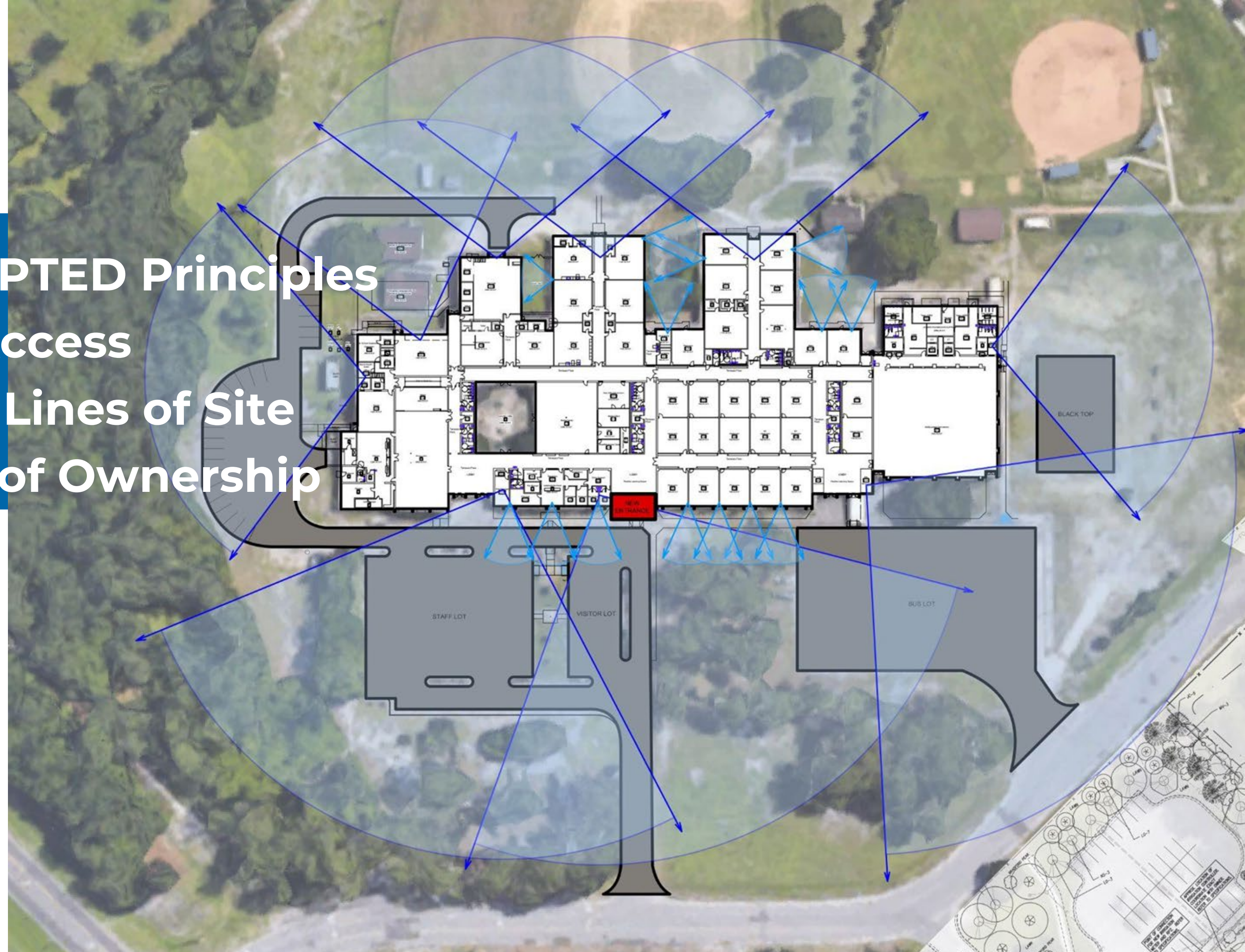

CLEAR POINT OF ENTRY



TRASK MS
PRIOR TO
2014 BOND
RENOVATIONS

CLEAR POINT OF ENTRY



TRASK MS
POST
RENOVATION

SIGNAGE



Clear and consistent signage prevents visitors from being in the wrong place at the wrong time

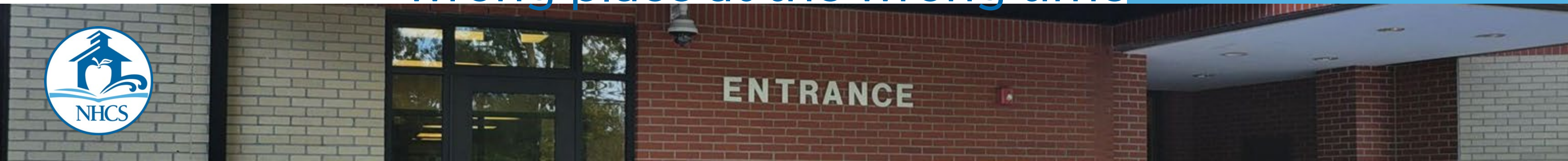

EXTERIOR DOORS

CLOSED AND LOCKED AT ALL TIMES

- Visitors Required to Check In at Main Office
- Currently 434 Electronic Locks District-Wide

As part of security upgrades,
door hardware is modified to
prevent potential for
chaining of doors



MAIN ENTRY

AI PHONES

- Located at all Campus Entrances
- Provides First Layer of Building Access Control
- Additional Units Added as Needed
- Two Consoles Provided for Office Staff Use



SECURITY VESTIBULES

Background Information

- Researched Best Practices Among Districts Nationwide
- Established Two-Point Verification Protocol
 - Remote Reception Visitor Interaction
 - Teller Window Visitor Interaction
- Designed to Slow Visitor Access
- Designed for Visitor Containment

CURRENT CAMPUSES WITH SECURITY VESTIBULES

- BLAIR ELEMENTARY*
- COLLEGE PARK ELEMENTARY*
- FREEMAN ELEMENTARY
- PORTERS NECK ELEMENTARY*
- WRIGHTSVILLE BEACH ELEMENTARY*
- NOBLE MIDDLE*
- TRASK MIDDLE*
- WILLISTON MIDDLE
- JC ROE
- LAKE FOREST ACADEMY

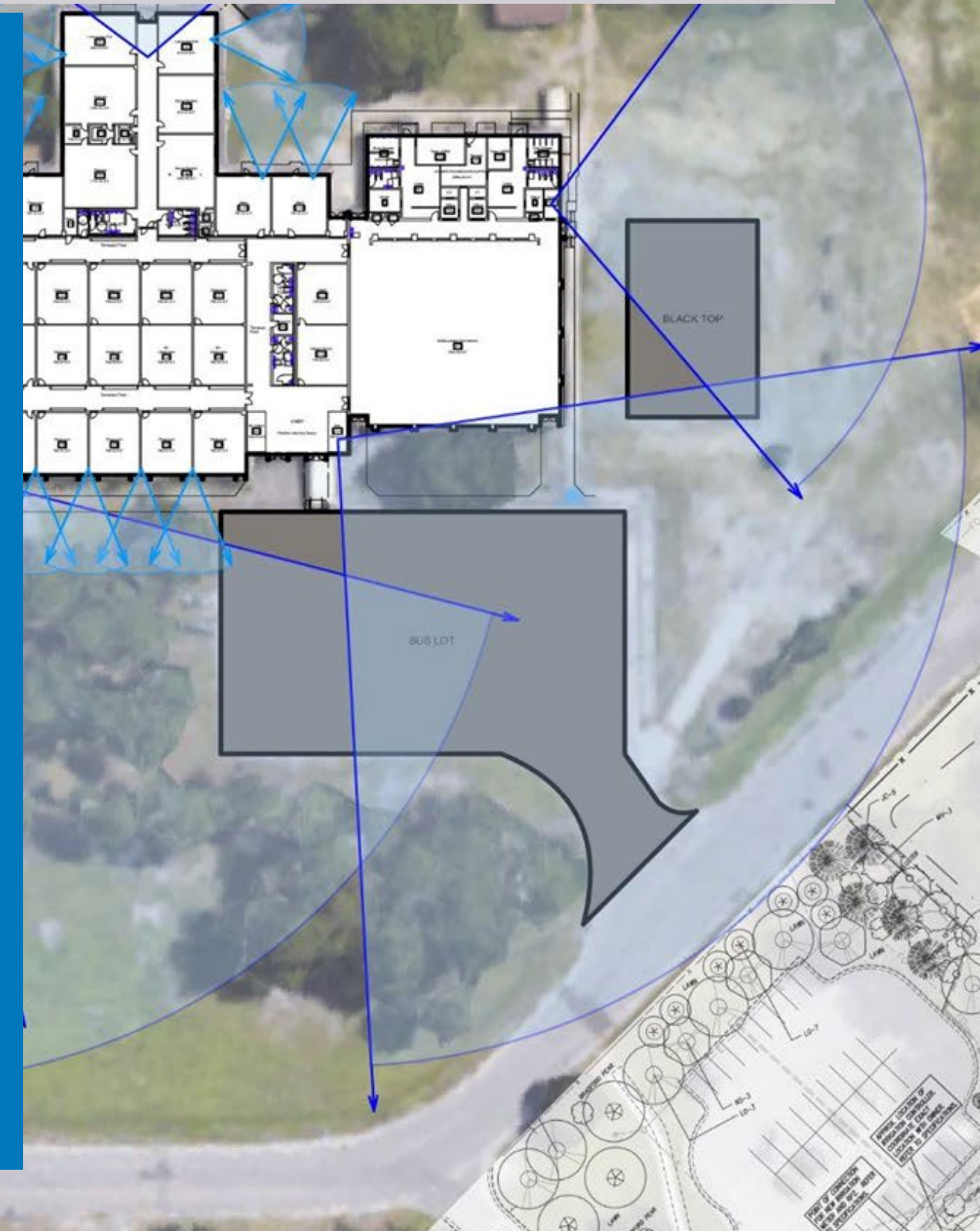

WILLISTON MIDDLE SCHOOL



**REMOTE RECEPTION
VISITOR
INTERACTION**

WILLISTON MIDDLE SCHOOL

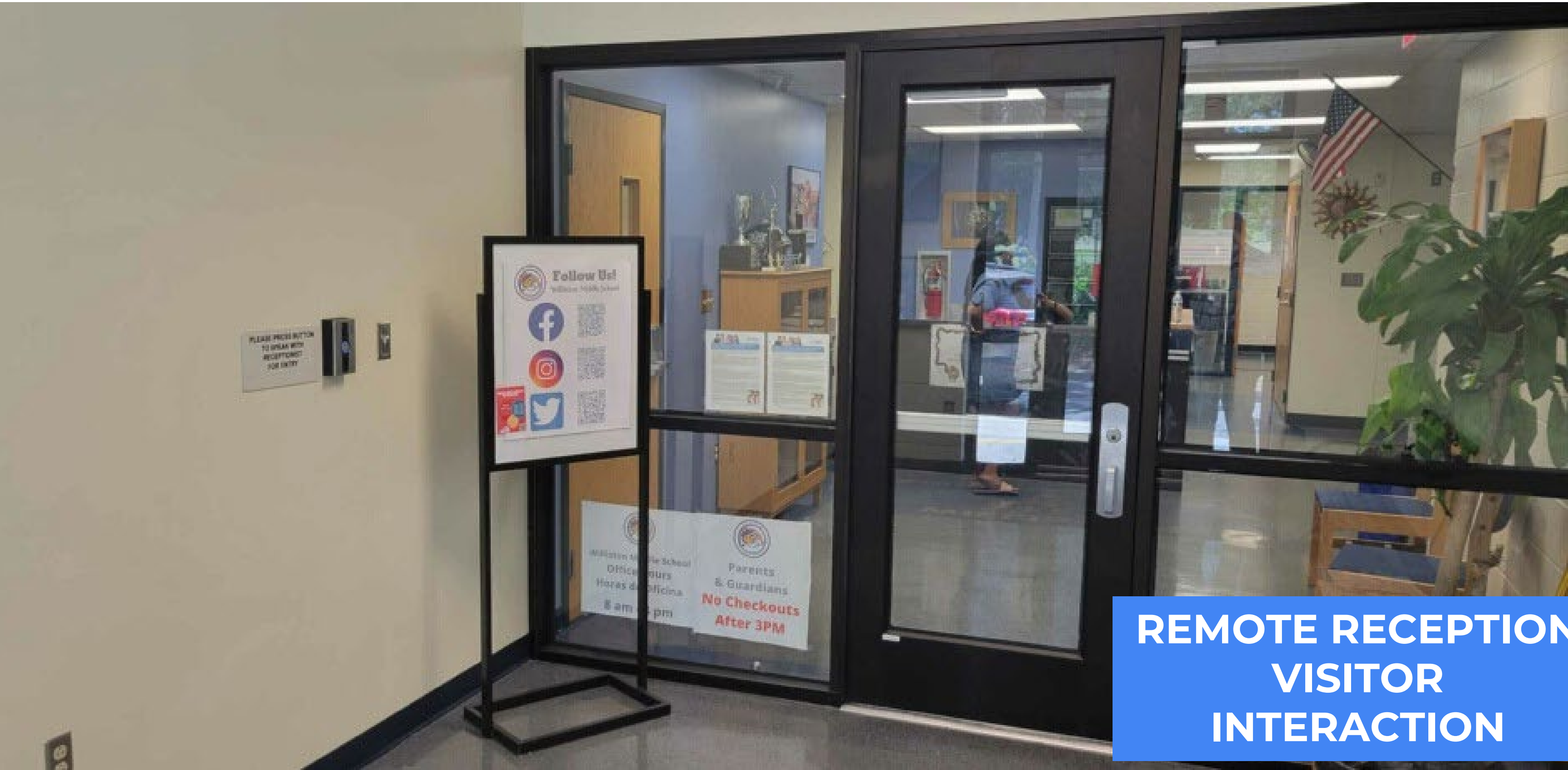

**REMOTE RECEPTION
VISITOR
INTERACTION**

UPCOMING SECURITY VESTIBULE PROJECTS

- INTERNATIONAL SCHOOL AT GREGORY
- HOWE PRE-K
- SPENCER BUILDING

NEXT IN QUEUE FOR SECURITY VESTIBULES

- NEW HANOVER HIGH SCHOOL
- ROLAND-GRISE MIDDLE SCHOOL
- LANEY HIGH SCHOOL
- ASHLEY HIGH SCHOOL
- HOGGARD HIGH SCHOOL

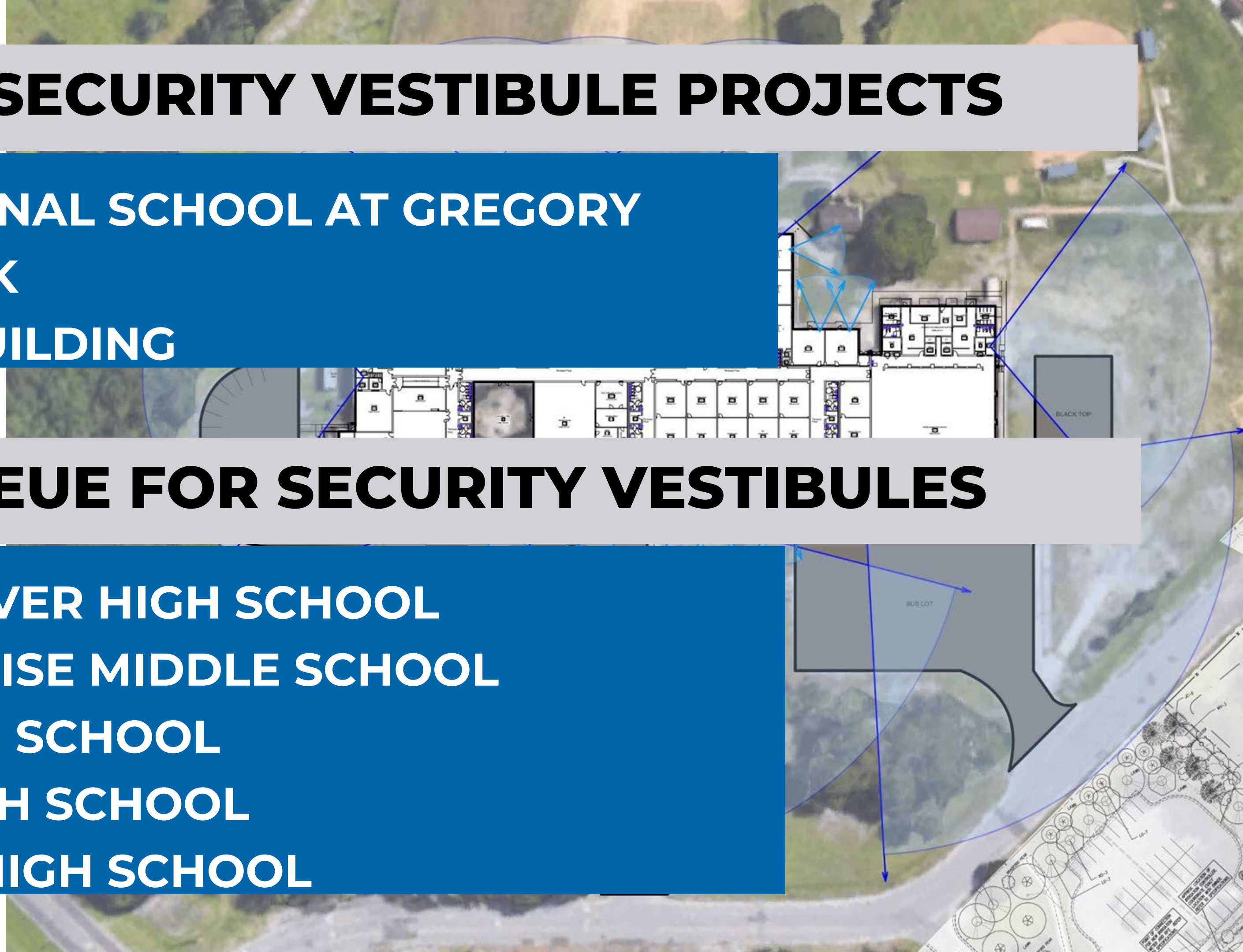

How we Physically Secure of Facilities

- Visitor Check-in System
- Security Cameras
- Interior Locks and Security Shades
- Communication and Notification Systems
- Intrusion Detection Systems
- Fire Alarm
- Emergency Shut-Offs
- Interior Design for Visibility



How We Physically Secure Our Campuses

- Implement Strategies within Site and Building Design
- Provide Written Procedures
- Provide Training and Promote Awareness
- Assign School Resource Officers

WHAT IS THE MOST IMPORTANT PART?

EACH ONE OF US



Questions?



#NHCSLeadingTheWay

